

GROHE RED

Made in Germany

99.0831.031/ÄM 245902/10.20

www.grohe.com

Pure Freude
an Wasser

GROHE

30 058

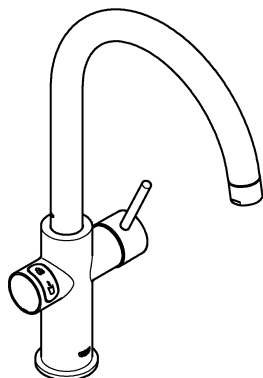

30 340
30 341

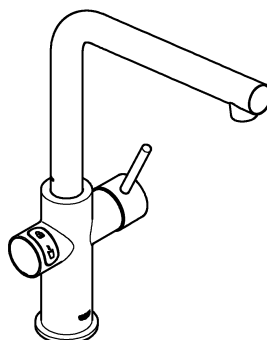

GB

..14

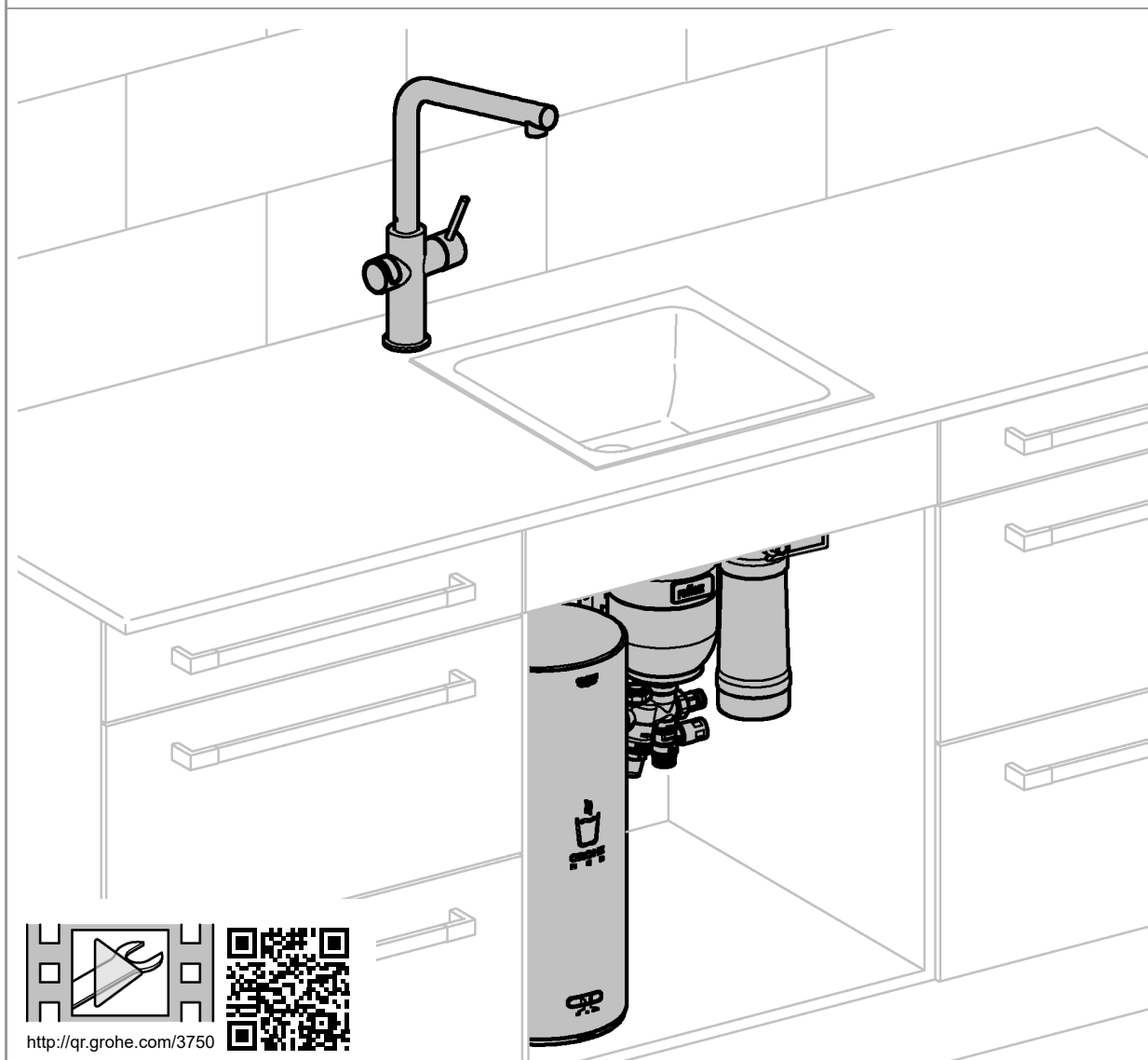

1

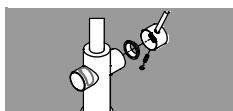

2



3 - 8

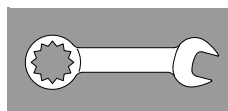

9 - 10



11

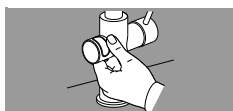

12 - 13



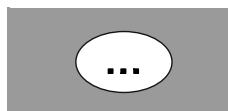

14 - 16



19

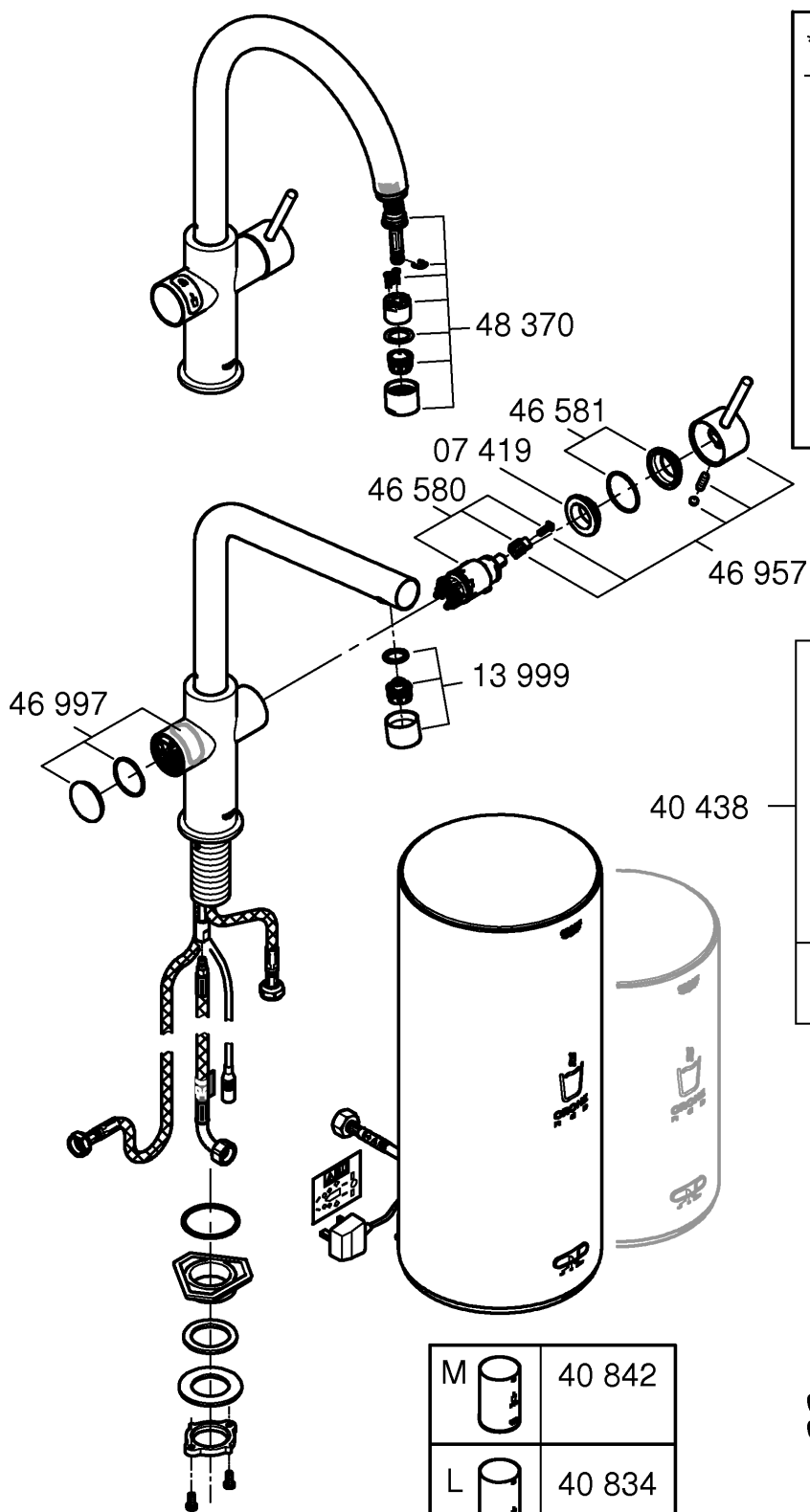



*40 841	*40 412
	*40 430
	*40 547 (AC)
	*40 575 (UltraSafe)
	*40 691 (Mg+Zn)
	

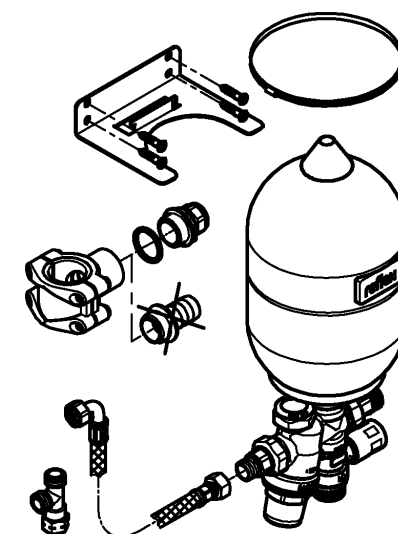
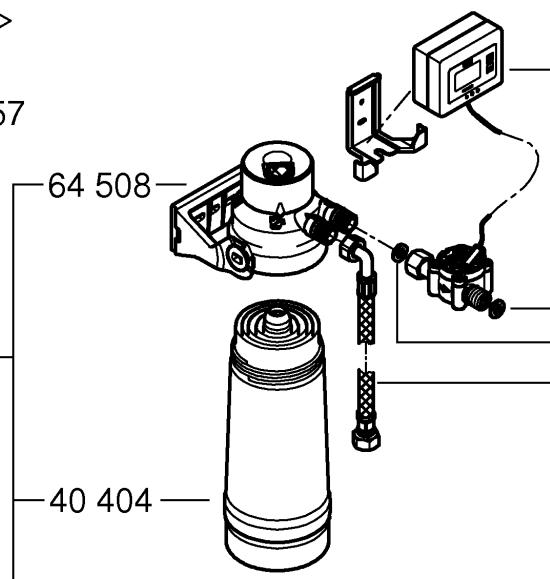

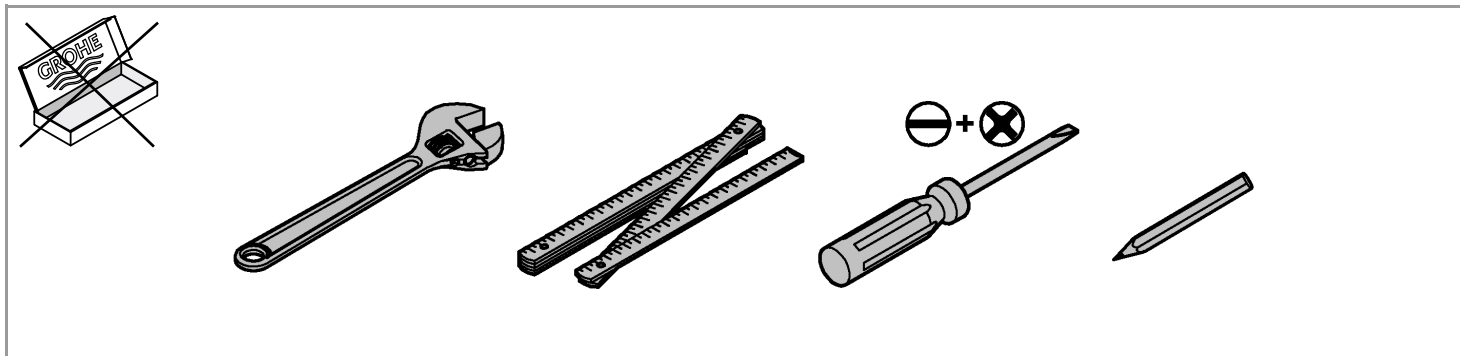
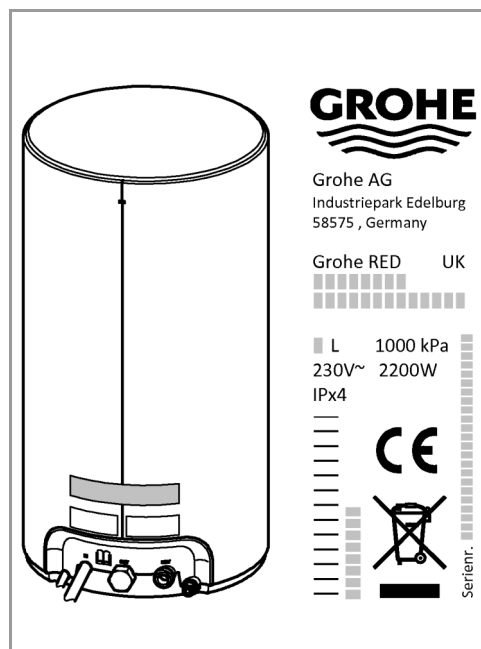
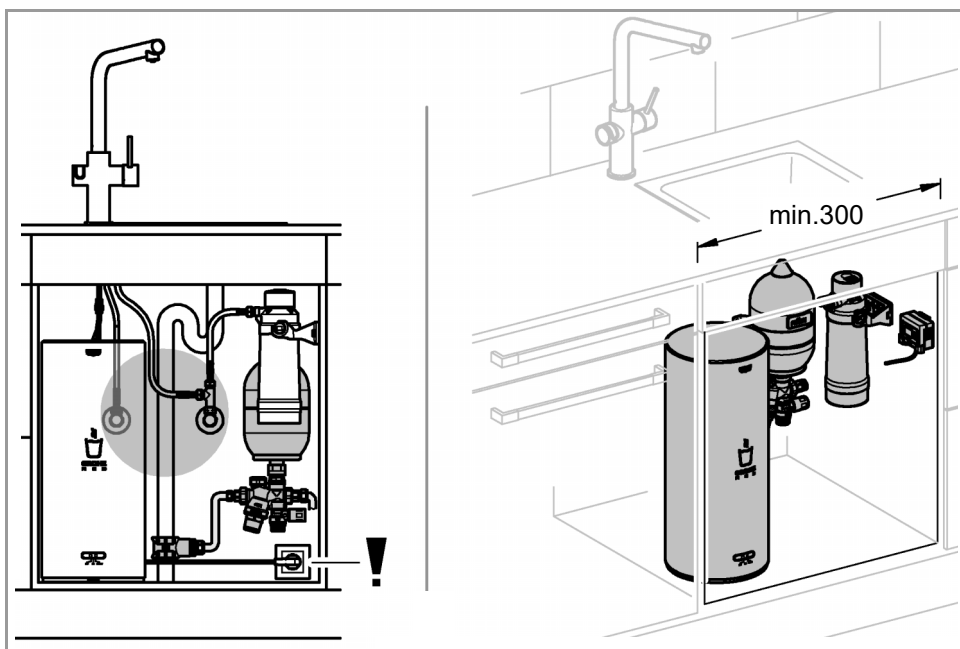
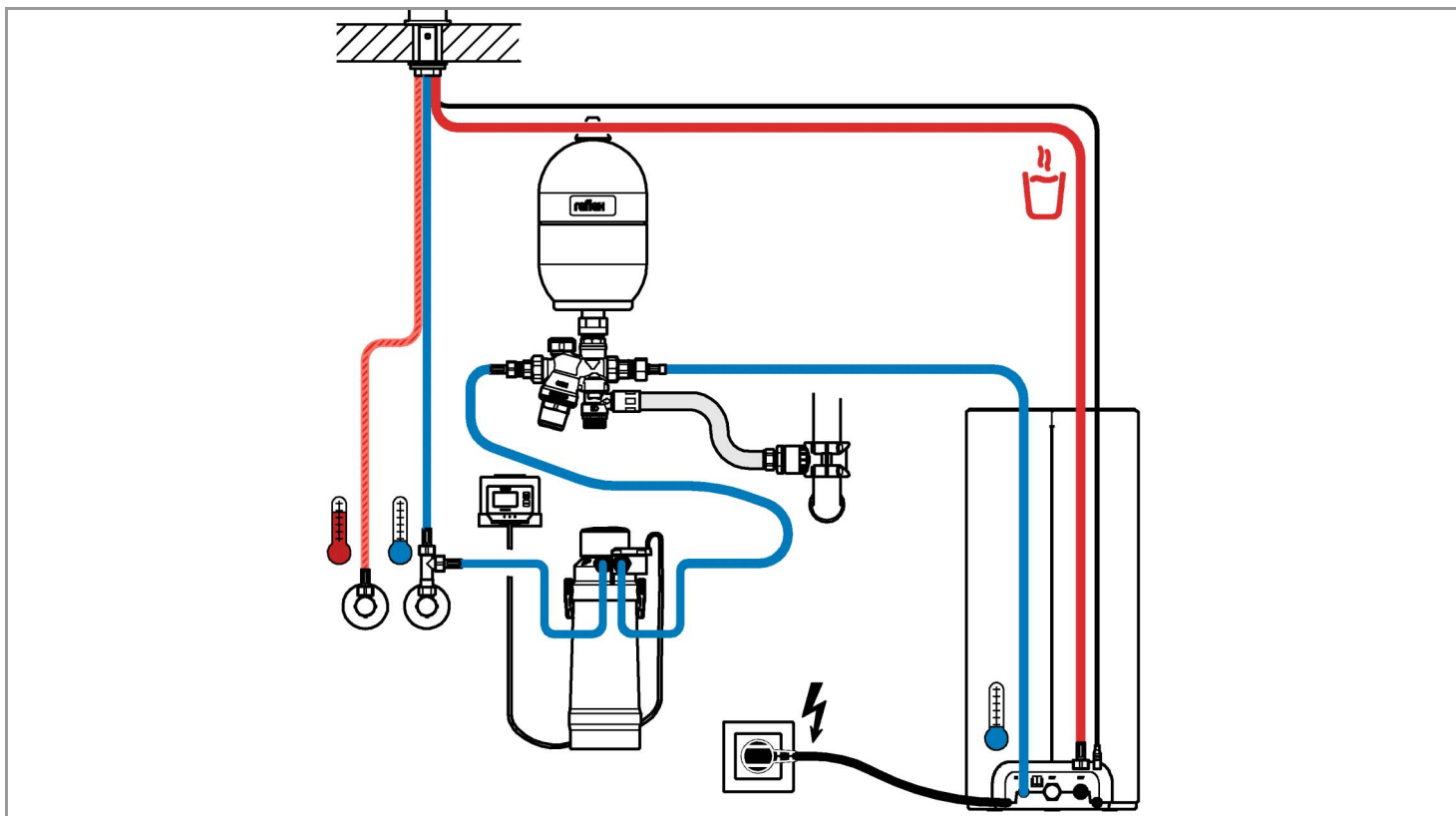



1

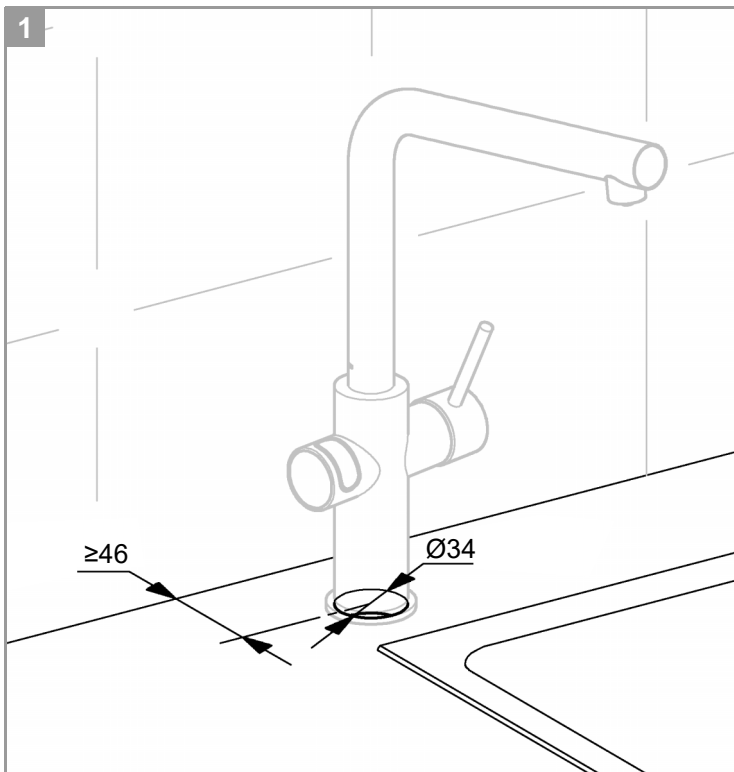

2

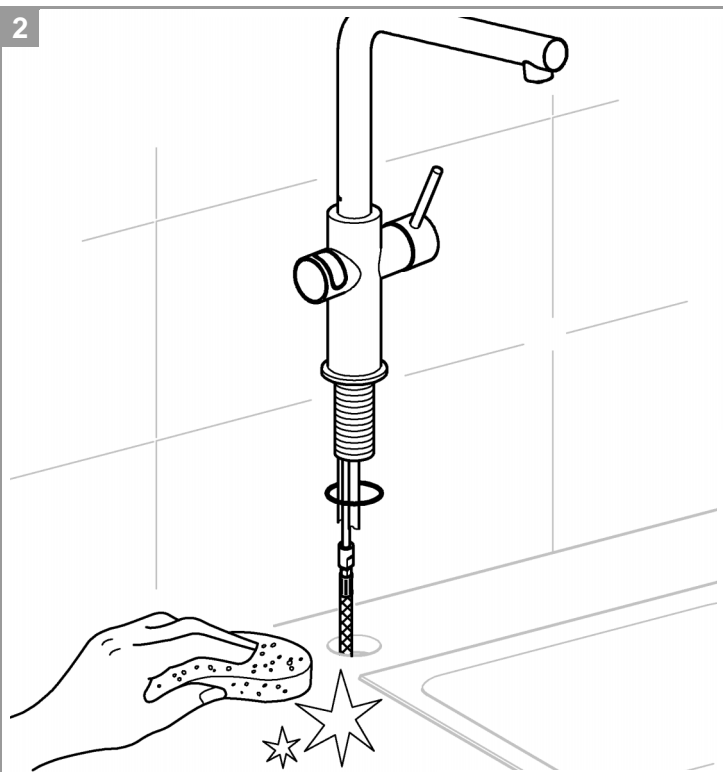

3

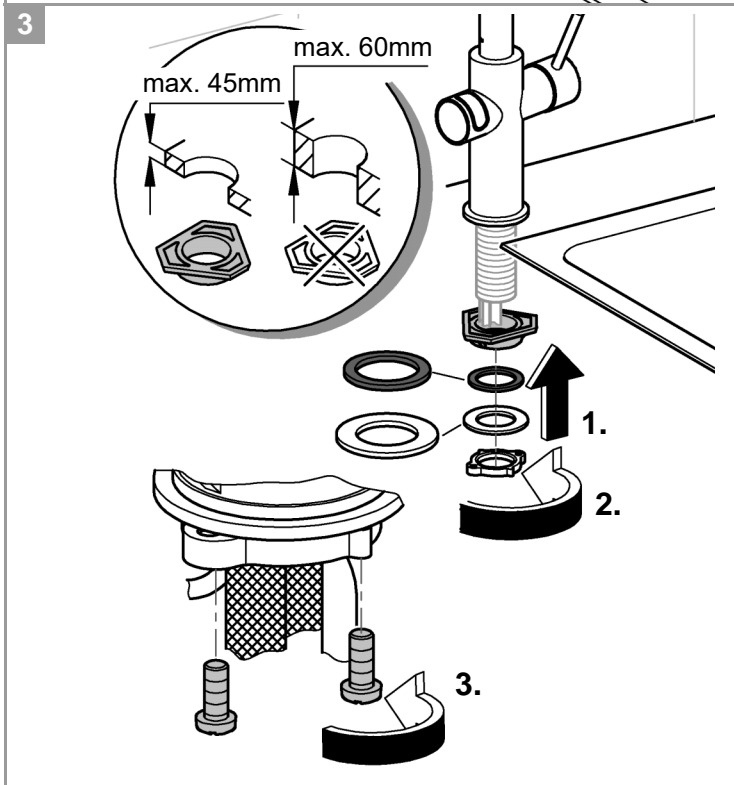

4

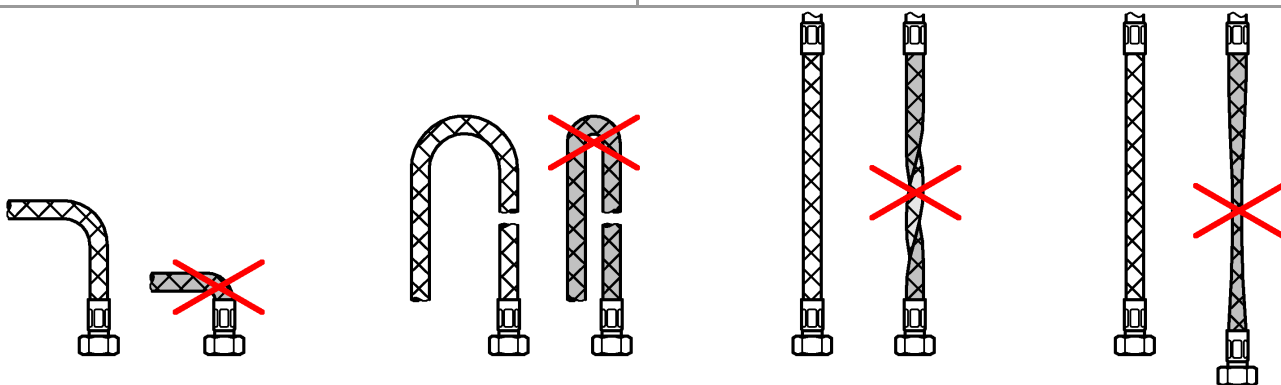
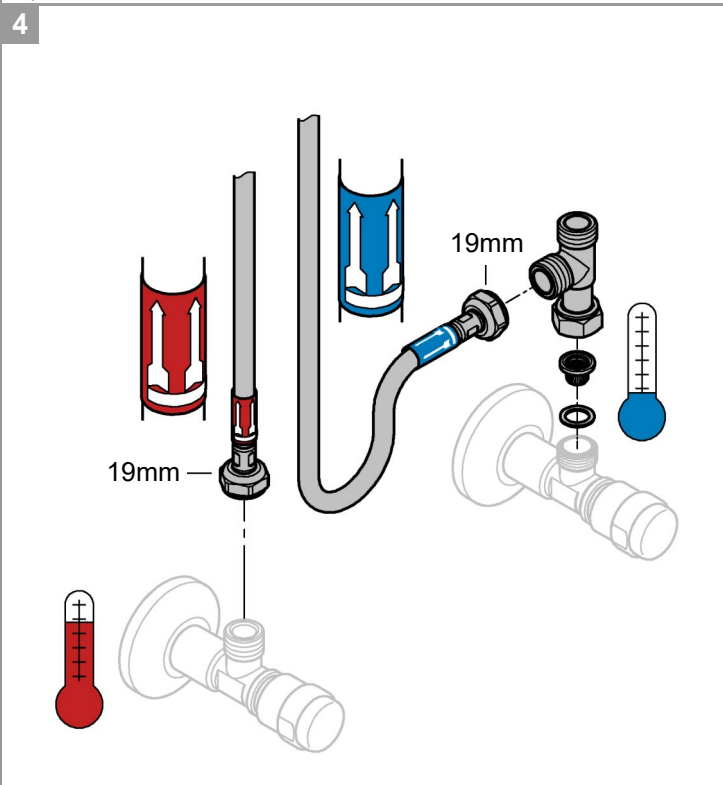



Determine local water hardness (°dKH/°dGH).

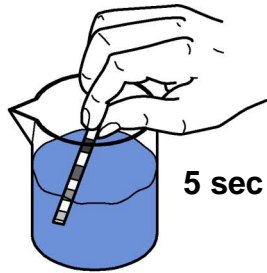

5 sec

°dKH
7 - 20

°dKH
<7

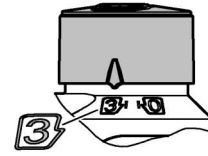
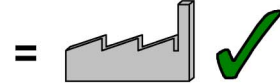
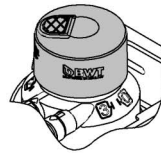

5

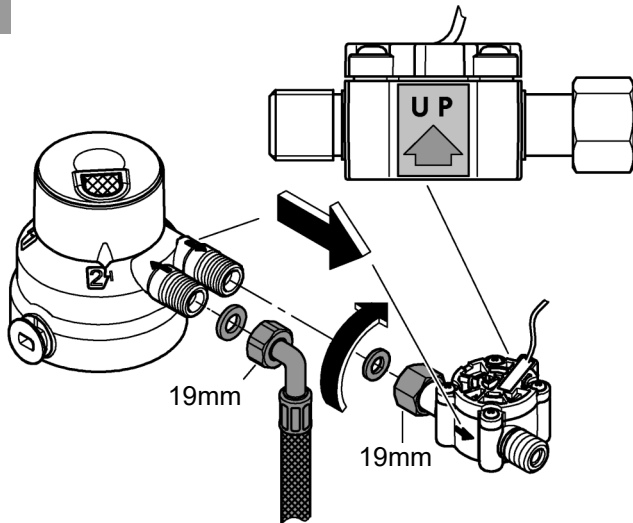

6

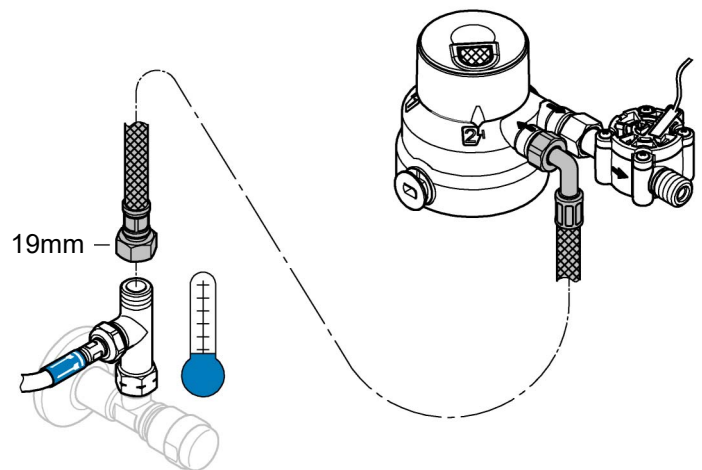

7

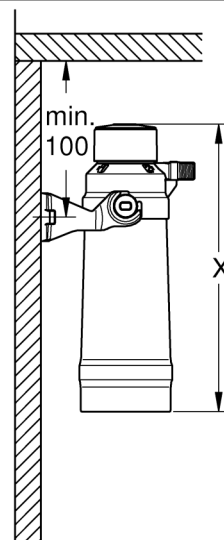
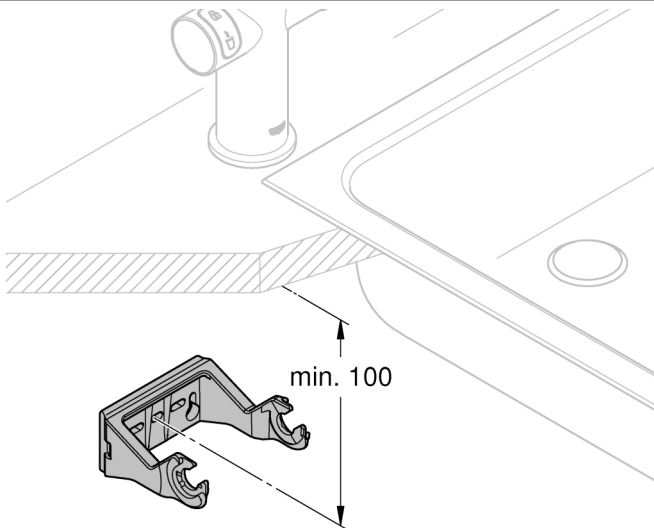

	X
40 404 S	270
40 430 M	350
40 412 L	386
40 547 Ac	270
40 575 UltraSafe	350
40 691 Mg+Zn	350

8a

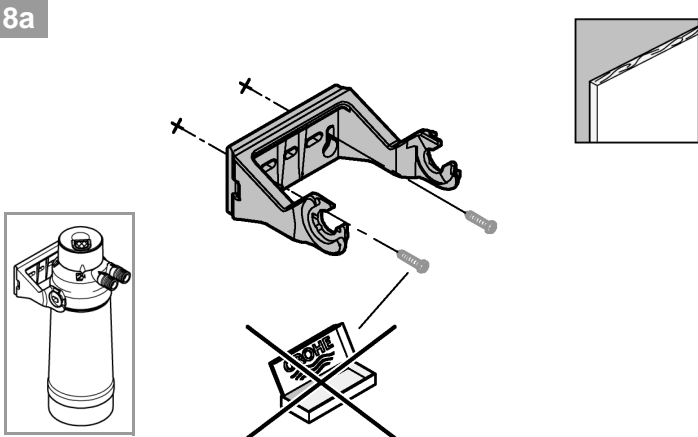

8b

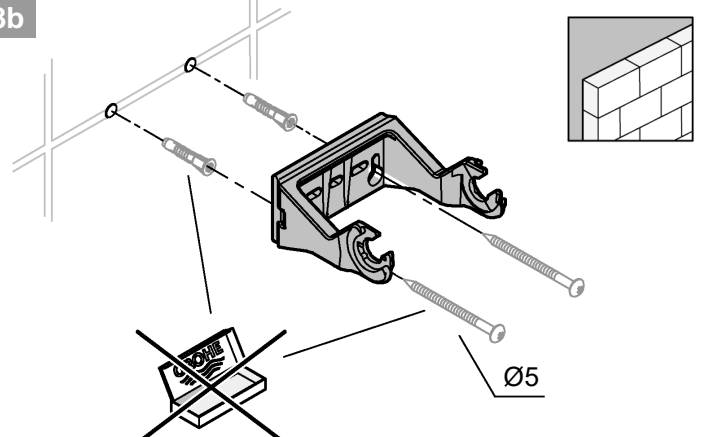

9a

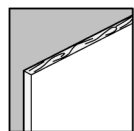
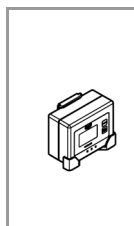

9b

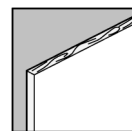
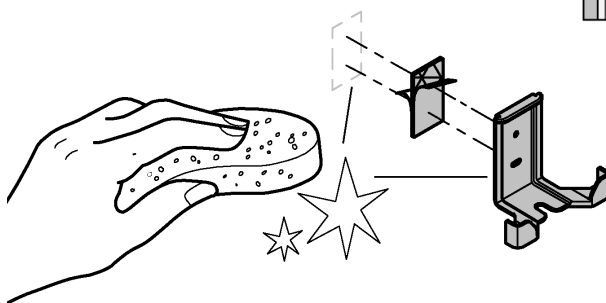

10

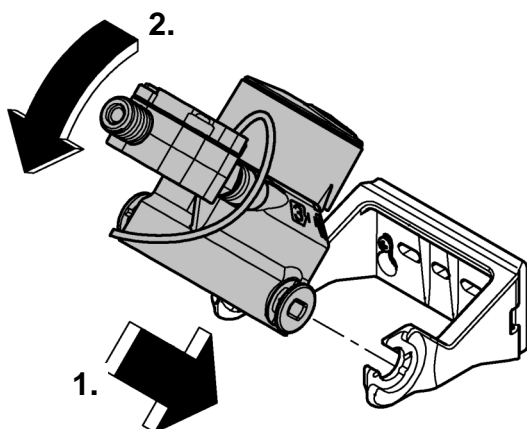

11

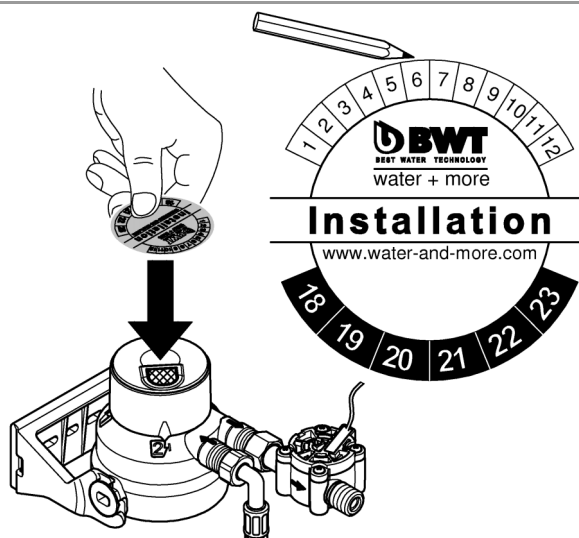

12

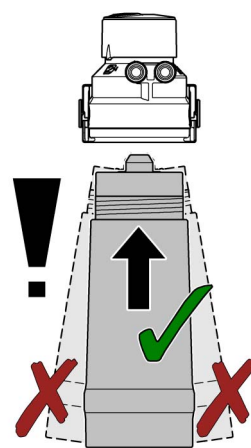
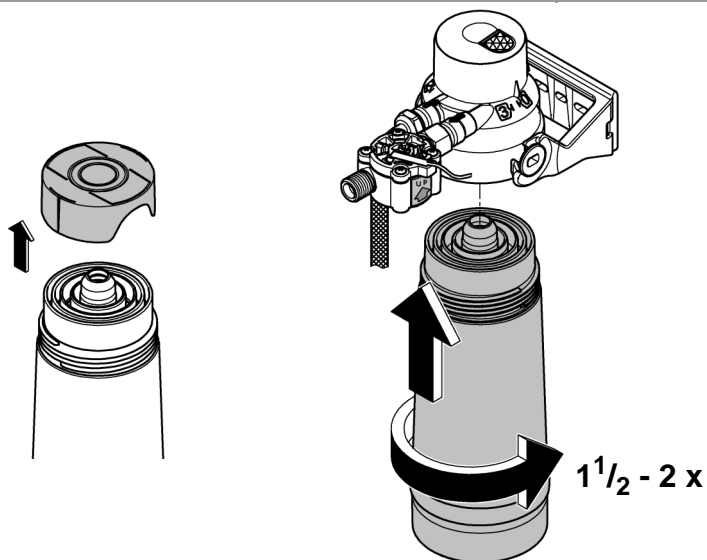

13

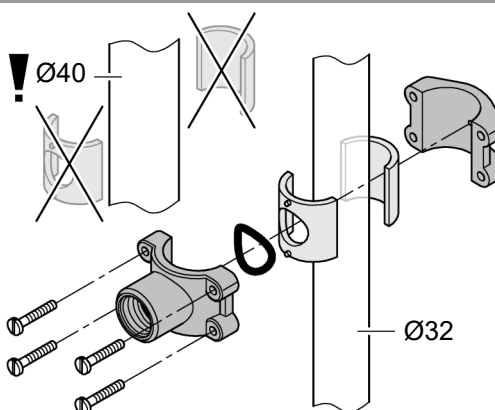
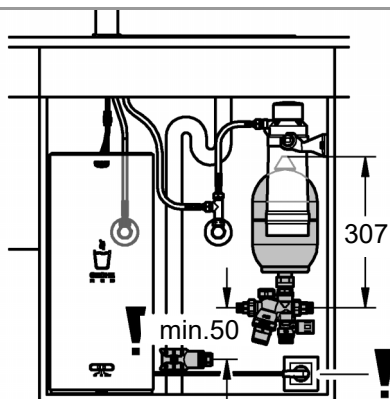

14

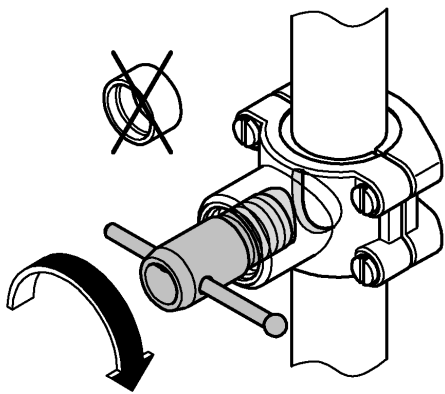

15

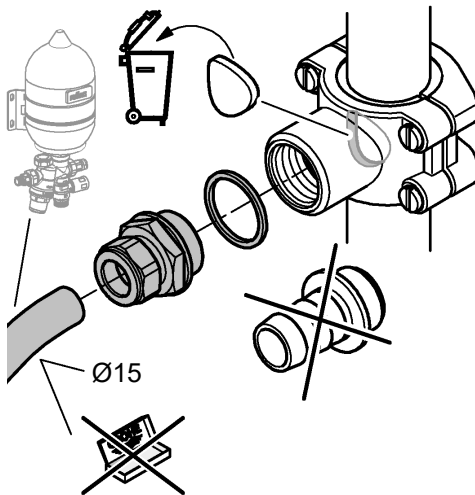

16

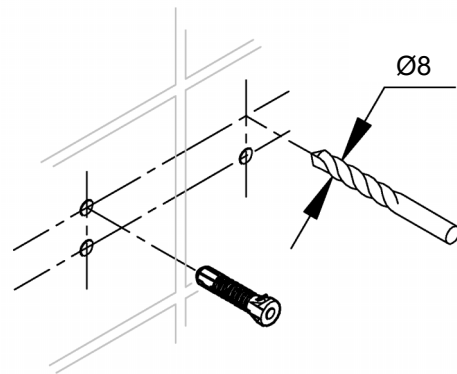

17

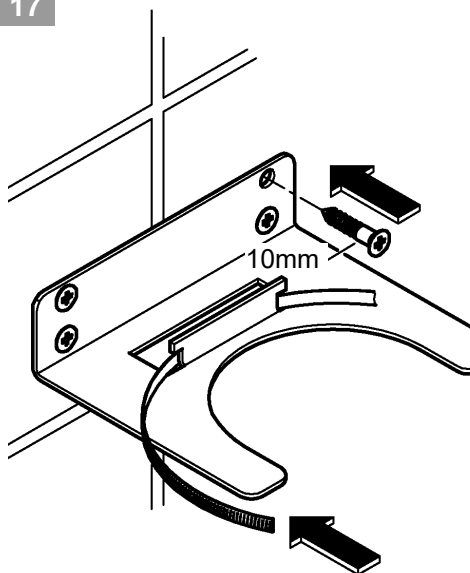

18

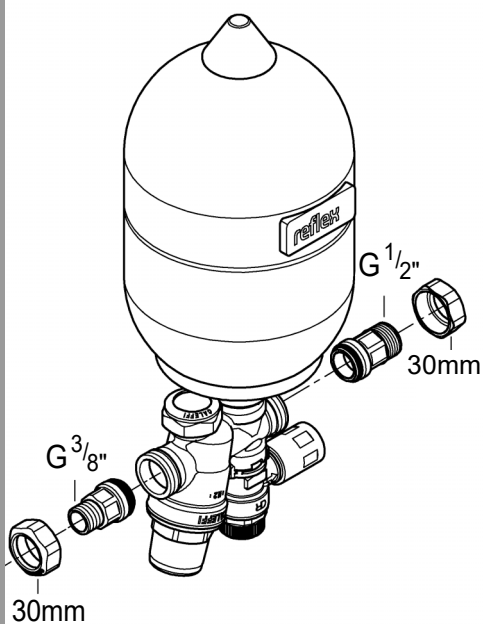

19

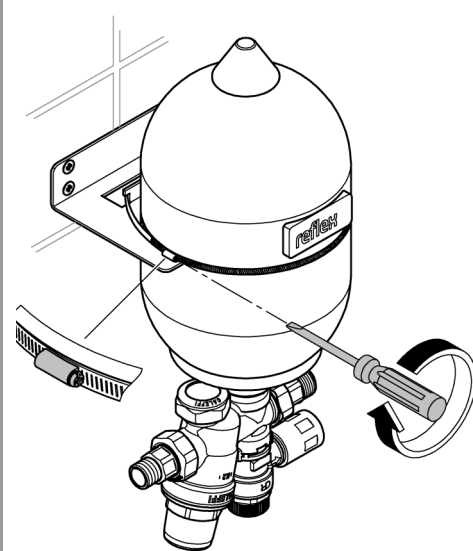

20

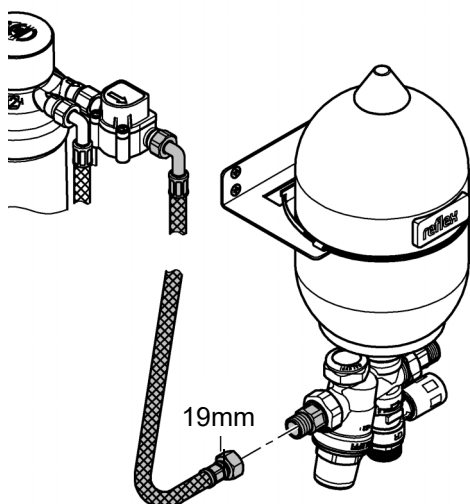

21

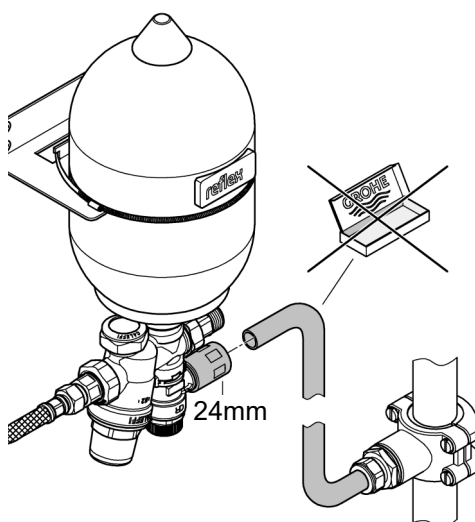

22

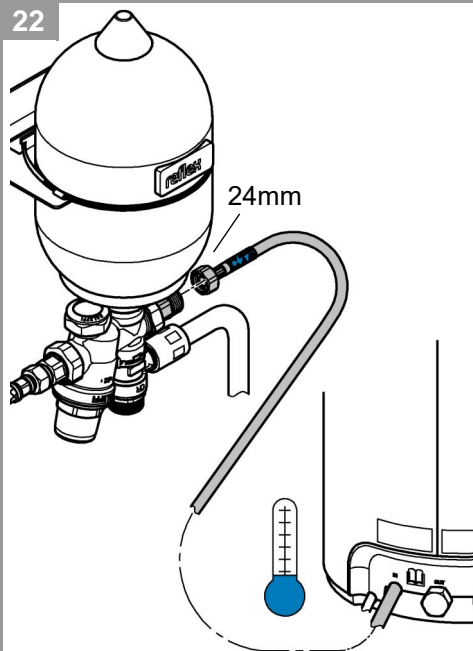

23

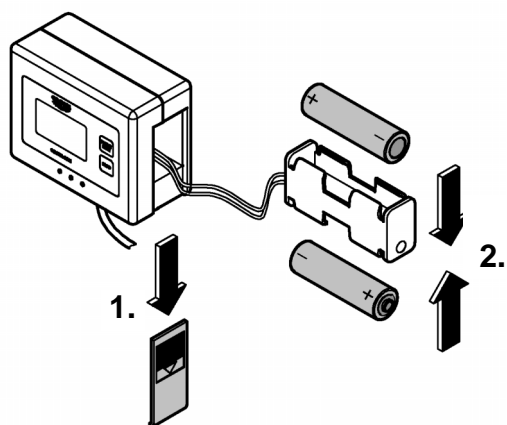

24

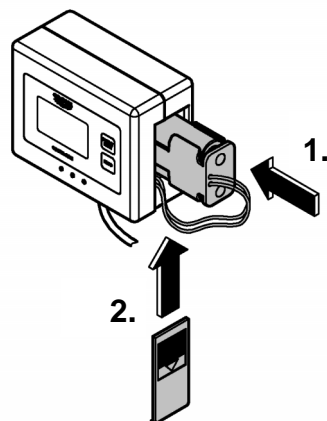

25

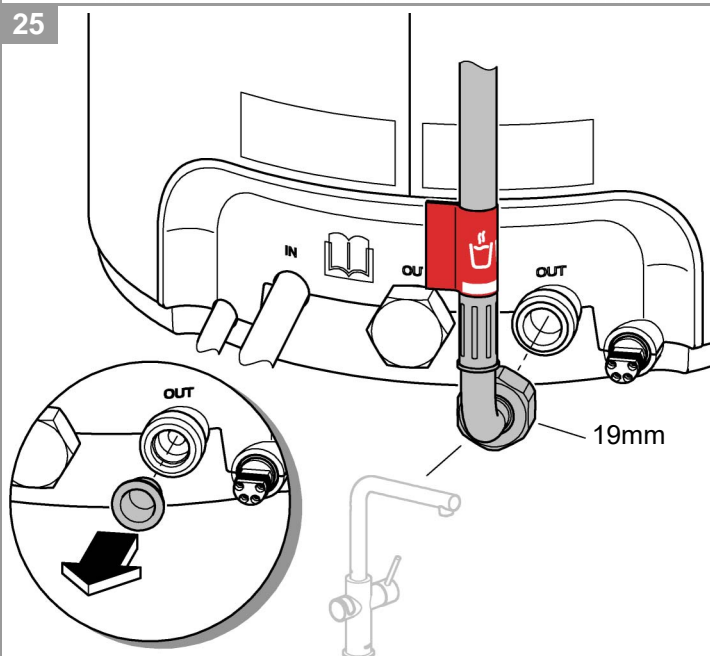

26

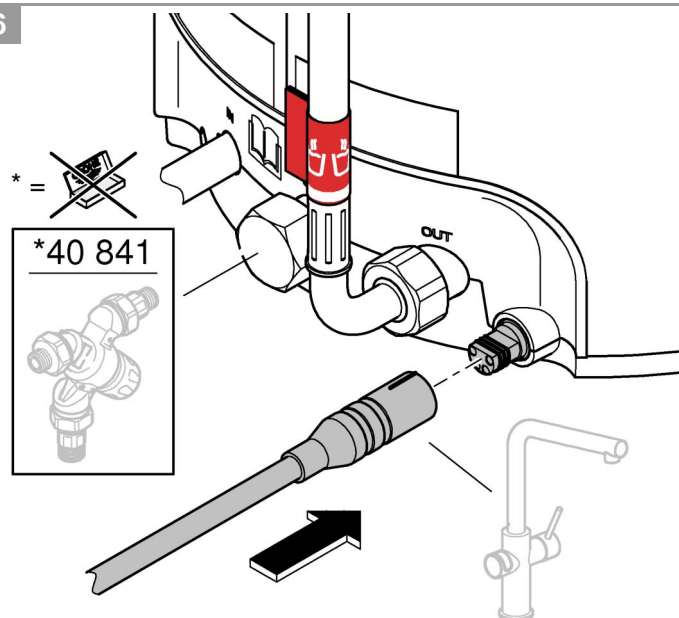

27

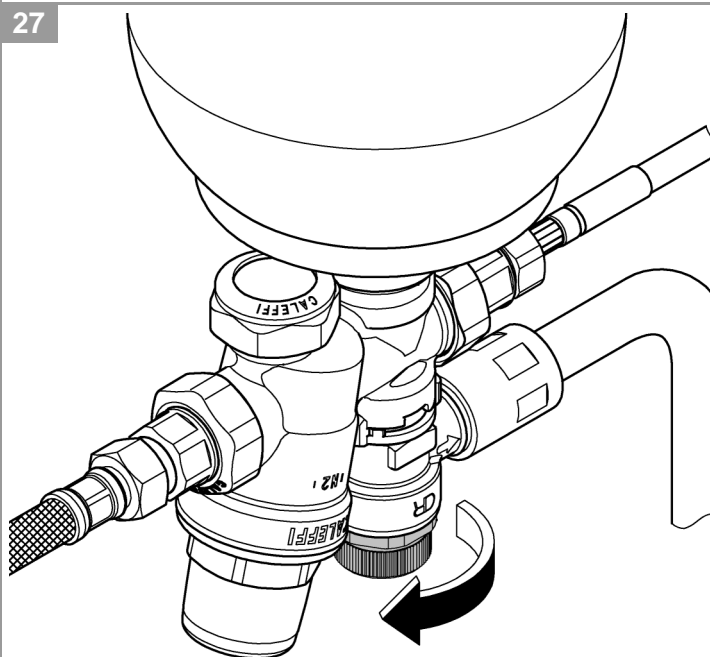

28

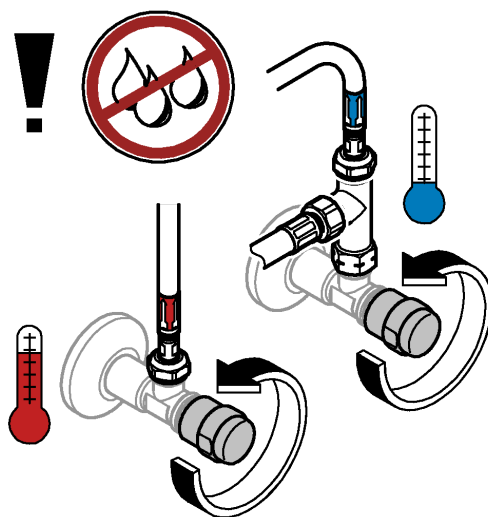

29

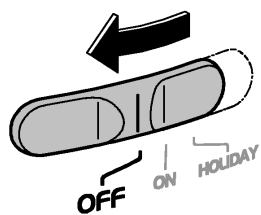

30

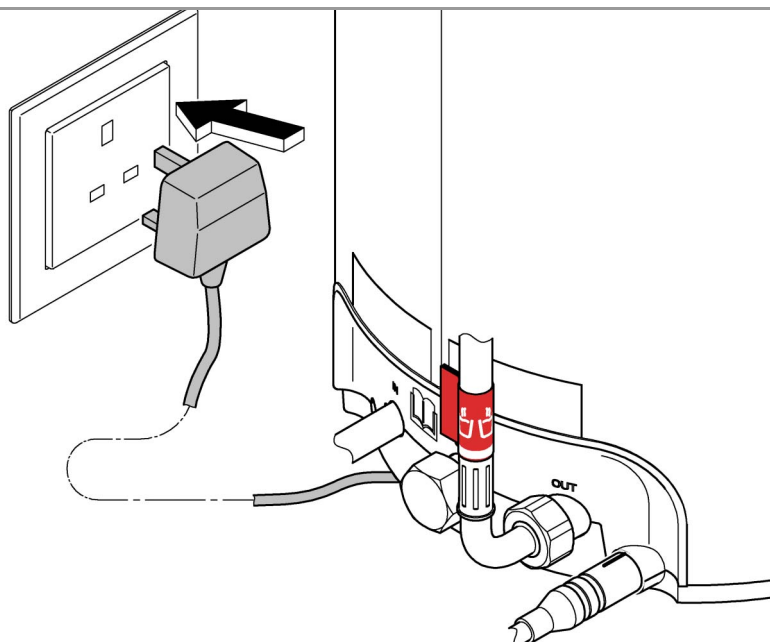

31

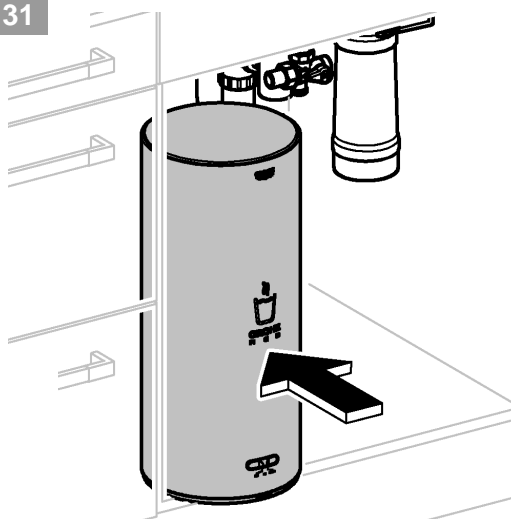

32

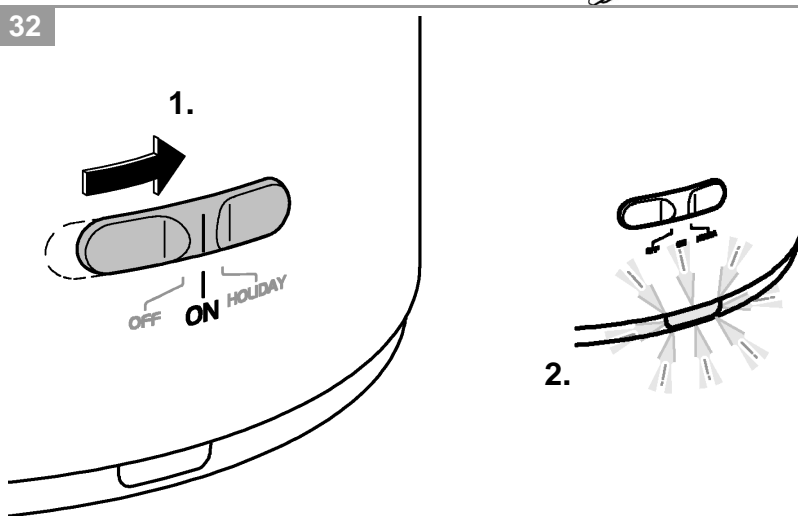

33

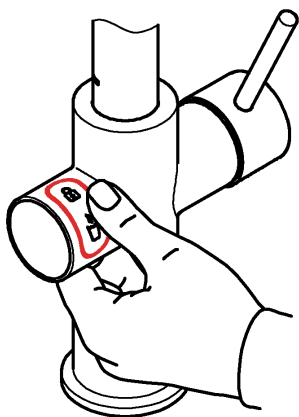

1.

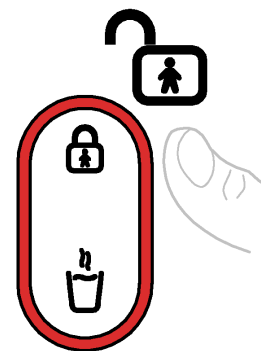
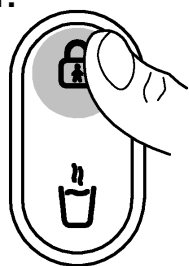

Press and hold.



Press several times.



Release.

2.





°dKH	Filter Capacity					°dGH		
	40404001	40430001	40412001	40547001	40575002			40691002
0	2000	4000	7600	3000	3000	< 7		1600
3	2000	4000	6500	-	-	7 - 9		1200
6	2000	4000	6500	-	-	10 - 12		700
10	1000	2500	4000	-	-	13 - 16		500
15	800	2000	3200	-	-	17 - 20		400
20	600	1500	2500	-	-	21 - 24		300
						25 - 32		200
						>32		100

Determine local water hardness (°dKH/°dGH).

Size	Day
S-Size	365
40404001	
M-Size	365
40430001	
L-Size	365
40412001	
Ac	365
40547001	
UltraSafe	180
40575002	
Mg+Zn	365
40691002	

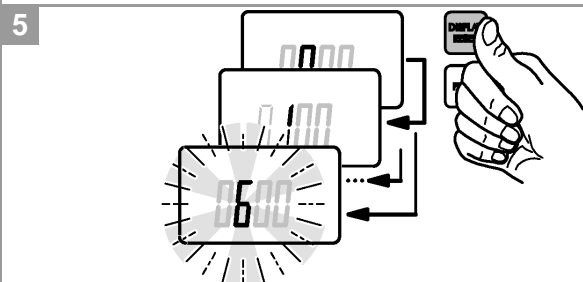
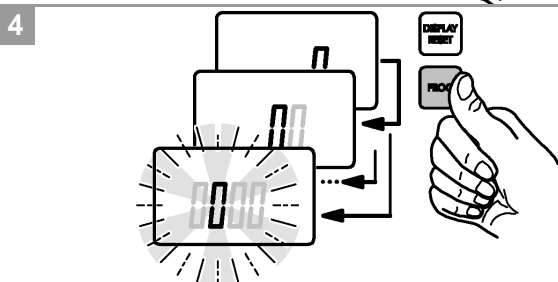
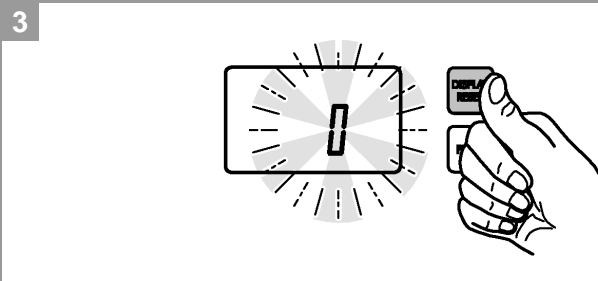
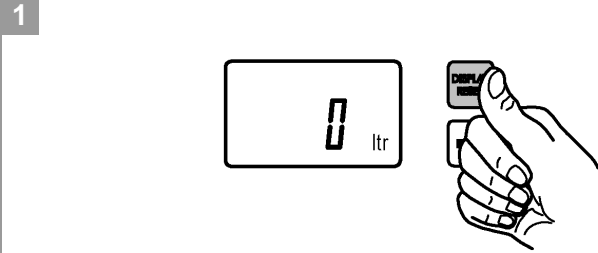
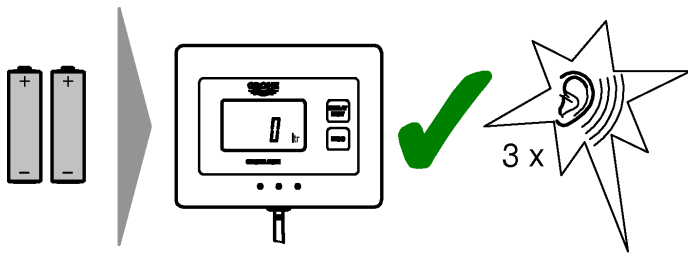
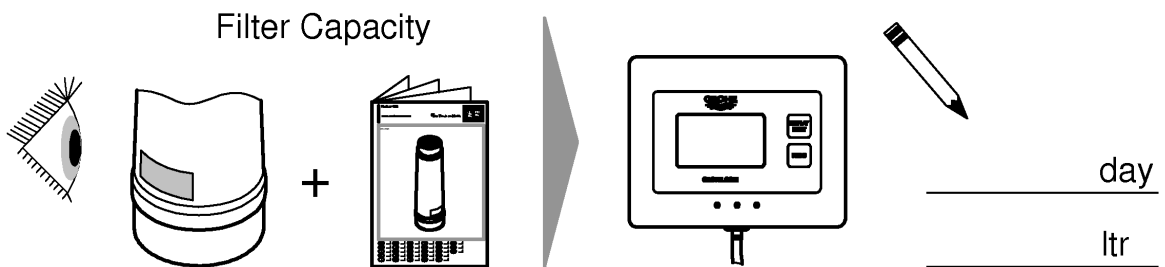



6

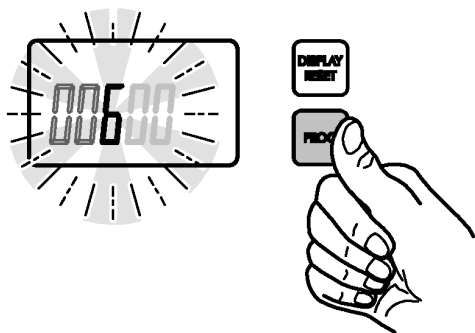

7

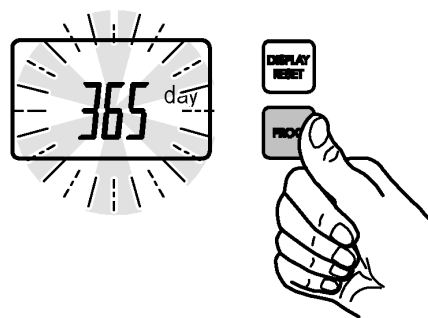

8

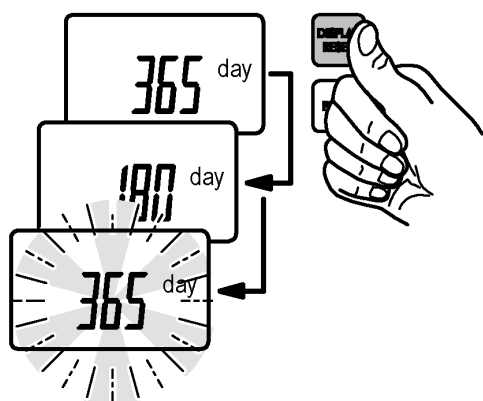

9

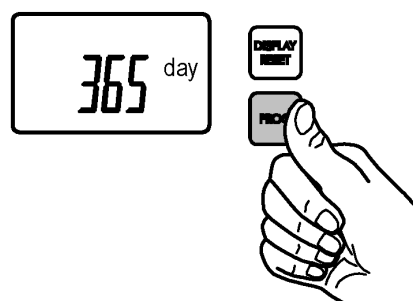

10

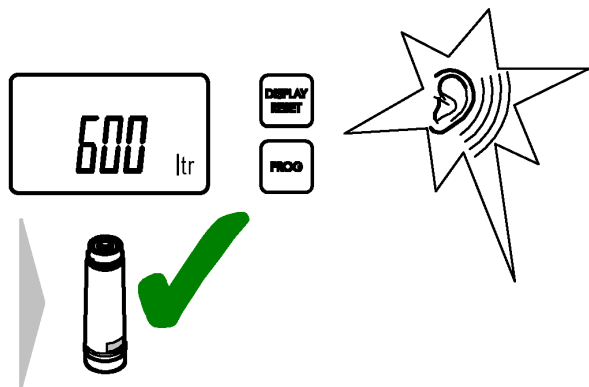

11

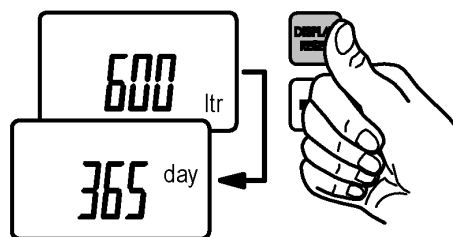

> 1min

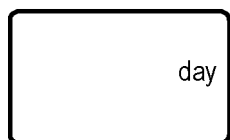
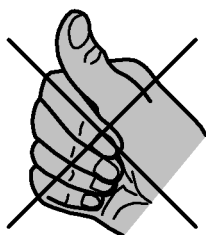

1

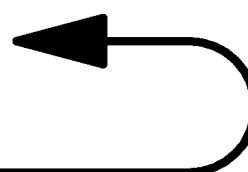

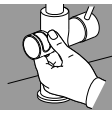

A



1

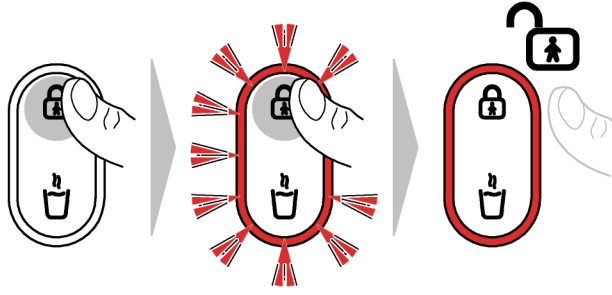

2



3

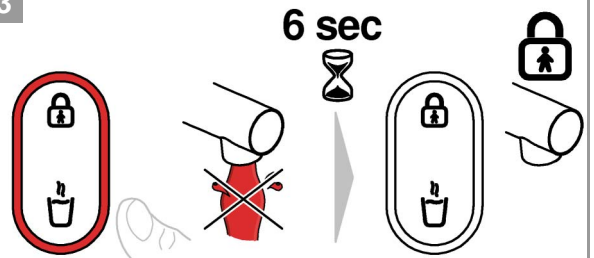

B



1

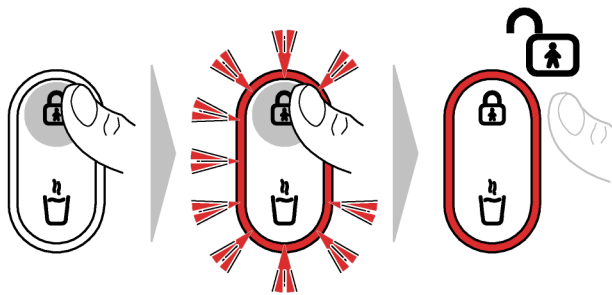

2

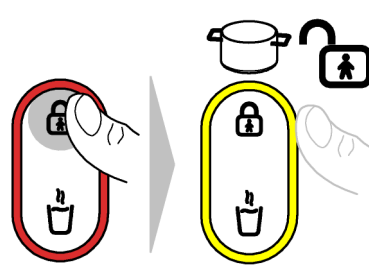

3

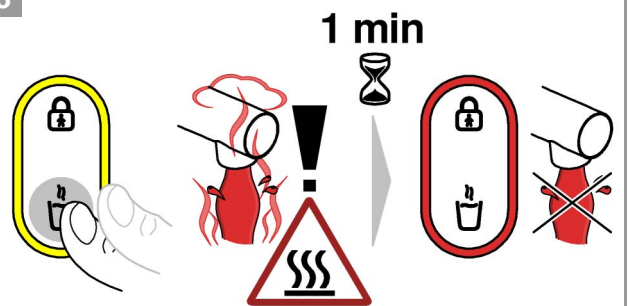

C

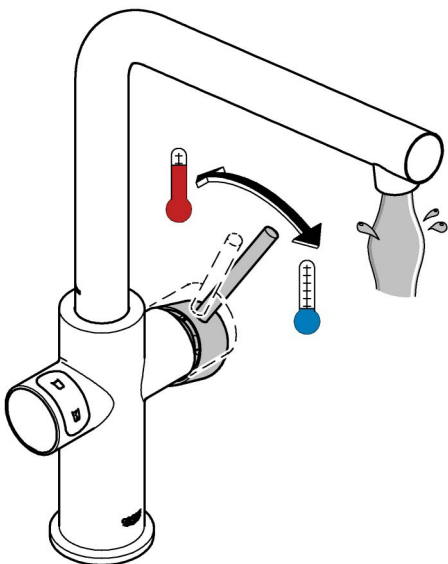

D

HOLIDAY

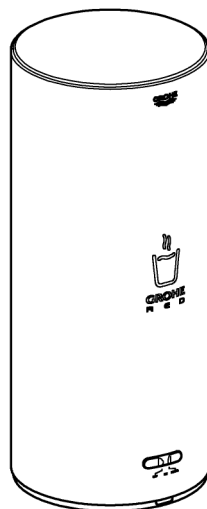

max. 60°C

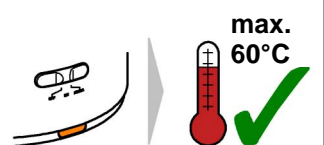
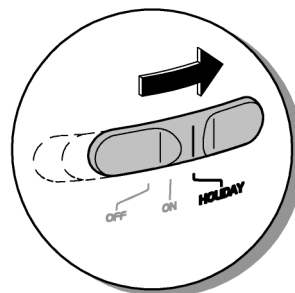
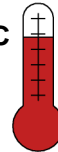

max. 60°C



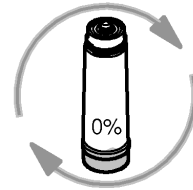
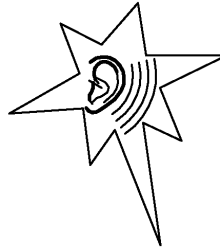
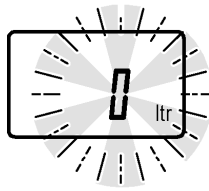

1



2

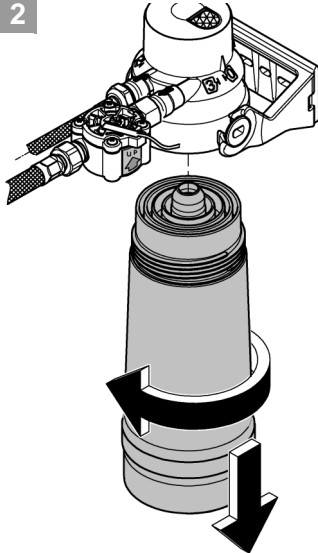

3

L-Size (*40 412 001)
M-Size (*40 430 001)
S-Size (*40 404 001)
Ac (*40 547 001)
UltraSafe (*40 575 002)
Mg+Zn (*40 691 002)

1 1/2 - 2 x

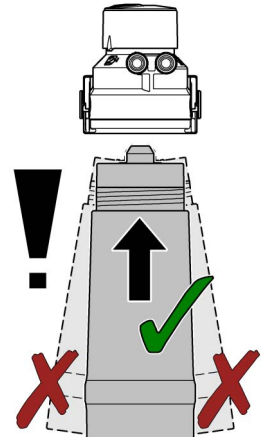
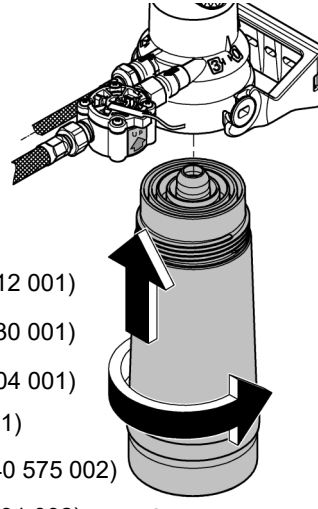

4

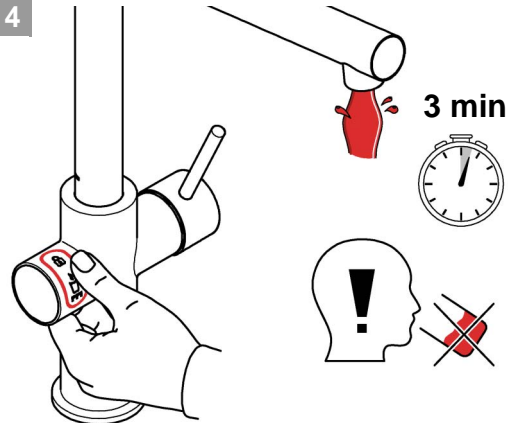

5

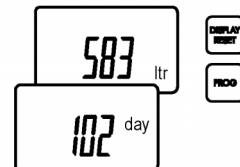
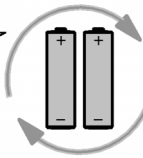
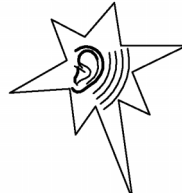
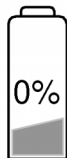
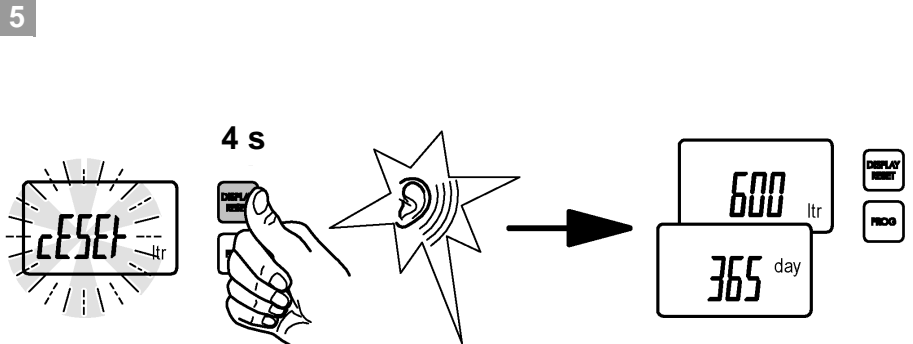

1

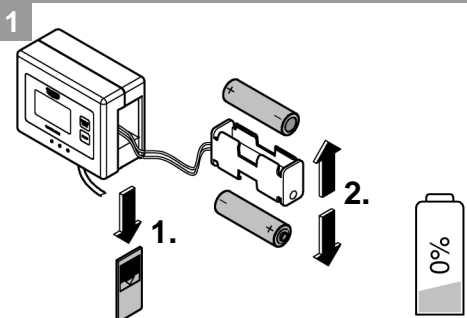

2

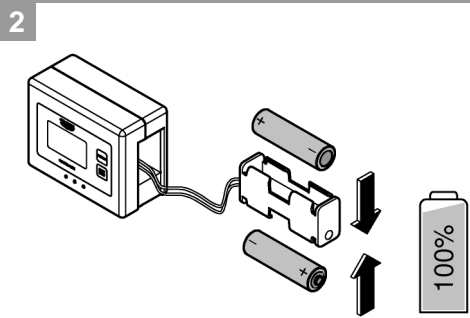

3

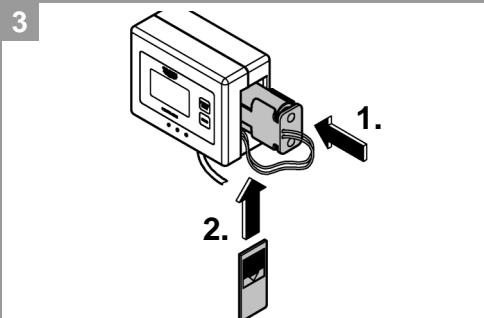

1

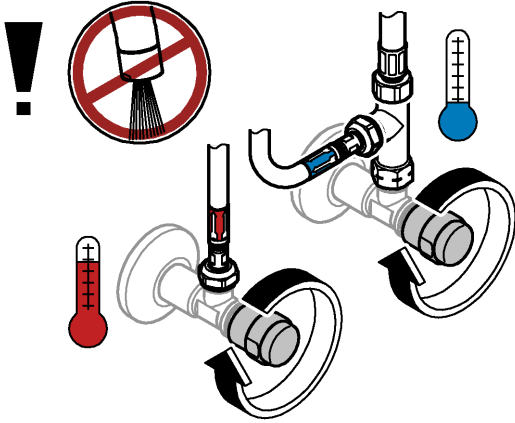

2

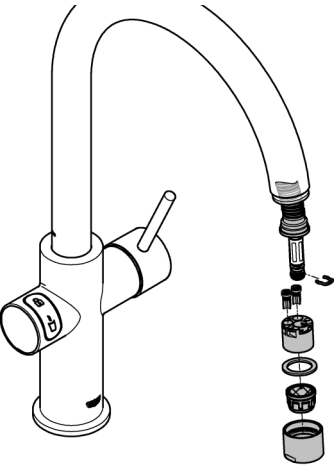
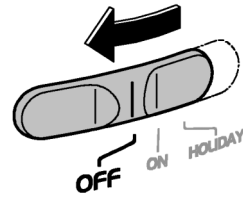

3

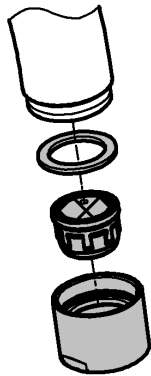

4

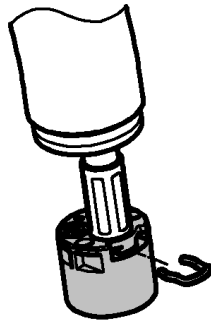

5

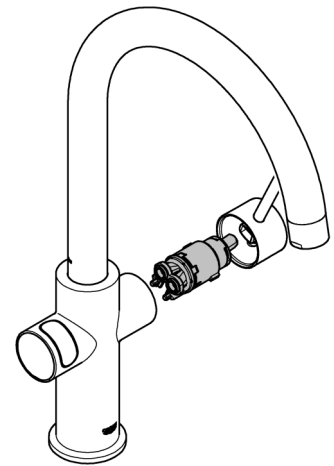

3

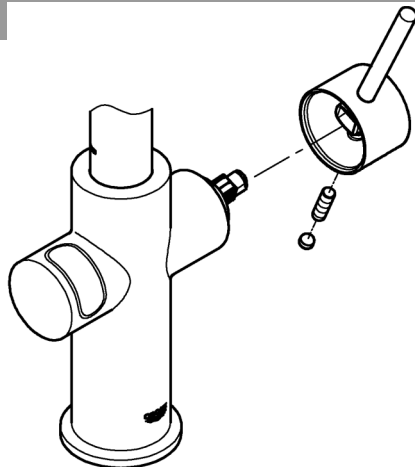

4

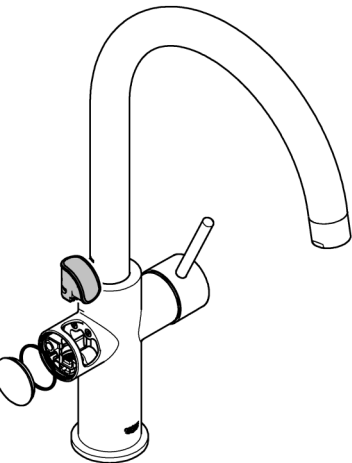
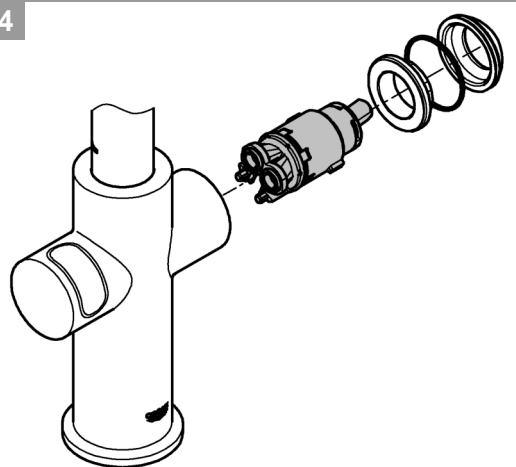

3

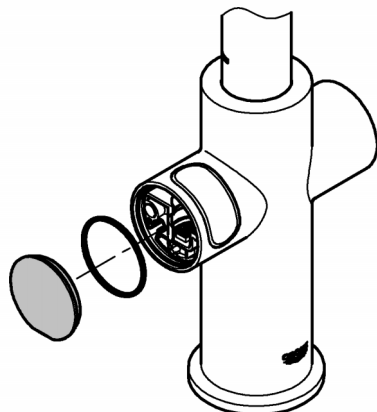

4

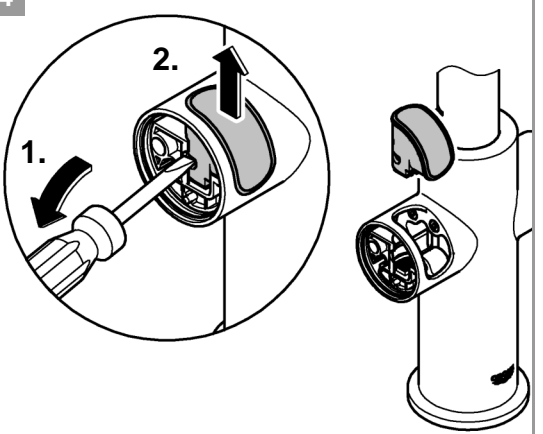

Safety information



This device may be used by **children** over 8 years of age, as well as persons with physical, sensory, or mental disabilities or inadequate experience and knowledge, if they are under supervision or were instructed in the safe use of the device and understand the resulting risks. **Children** must **not** play with the device. Cleaning and **user maintenance** must **not** be carried out by **children** without supervision.

Prevent danger resulting from damaged power supply cables. In the case of damage, the mains cable **must** be replaced by the manufacturer or his customer service department, or an equally qualified person.



Caution: risk of scalding. Escaping water is boiling hot. Never touch the end of the spout in order to swivel it, as it becomes extremely hot.

- The installation and use of GROHE Red is subject to the applicable national regulations.
- The boiling water storage heater must be connected to a permanent voltage supply of 10 A and residual current device. Ensure the system is earthed. If in any doubt, the electrical installation should be checked by a qualified electrician. The socket must be freely accessible after installation is complete.
- The installation **may only** be performed in frost-free rooms.
- The boiling water storage heater is **only** suitable for indoor use.
- The boiling water storage heater **must** be placed in an upright position.
- The boiling water storage heater must **not** be directly or indirectly sprayed with water when cleaning.
- The boiling water storage heater must not be opened.
- Use **only genuine replacement parts and accessories**. The use of other parts will result in voiding the warranty and the CE marking, and could cause injury.
- Do not use a damaged device.
- The filter head **must be** replaced after 5 years by the **GROHE service**.
- The use of extension cables is **not** permitted between the electrical socket and boiling water storage heater connection.
- The boiling water storage heater **must** be used with the safety assembly supplied.
- To ensure uninterrupted function of the safety assembly, it is advisable to have maintenance work carried out regularly.
- The boiling water storage heater may only be used with a GROHE Red fitting.
- Do **not** connect the hot water connection of the fitting to the hot water outlet of the storage heater. A mixing valve **must** be used (special accessory *40 841), as necessary.
- If the operating pressure is insufficient, the boiling water storage heater **must** be switched off.
- In order to transport the boiling water storage heater, it **must** first be emptied. To do this, the safety assembly must be disconnected from the boiling water storage heater.
Caution: risk of scalding. Escaping water is boiling hot.
- No liability can be accepted for damage that occurs due to non-observance of the operating instructions.

Technical data boiling water storage heater:

- Connection: wall socket with earth wire, protected via a 10 A fuse
- Installation elevation: max. 2000 m above sea level
- Voltage supply: 230 V AC / 50 Hz
- Max. power consumption: 2200 W
- Type of protection: IP X4
- Relative humidity: max. 95 %
- Ambient temperature: 0–40 °C
- Standby power loss (switched on): M: 14 W
L: 15.7 W
- Standby power loss (holiday mode): M: 5 W
L: 7 W
- Standby power loss (switched off): 1 W
- Energy efficiency class: A

Sanitary data:

- Boiling water storage heater capacity: M: 4 l
L: 7 l
- Available storage heater volume at 100 °C: M: approx. 3 l
L: approx. 5.5 l
- Flow pressure:
 - min. 0.2 MPa
 - recommended 0.2–0.5 MPa
- Operating pressure: max. 0.8 MPa
- Test pressure: 1.6 MPa
- Flow rate at 0.3 MPa flow pressure
 - mixed water: approx. 6 l/min
 - boiling water: approx. 3 l/min
- Boiling water temperature: 99 °C
The actual temperature may differ slightly due to different ambient pressures.
- Heating time from 10 °C to 99 °C: M: approx. 20 min
L: approx. 30 min
- Clamping length of fitting: max. 60 mm
- Water connection to storage heater: cold water
- Water connection fitting: cold/hot water from the service valve
boiling water from storage heater

The filter system with ion exchanger (S, M, L or Mg+) which is included **must** be used in regions with a carbonate hardness exceeding 10 °KH. The relevant water supplier can provide information on the carbonate hardness.

Thermal disinfection of the fitting is possible.

Confirmation

Status	Storage heater LED	Fitting LED
Initialisation	white	-
Heating phase	red, flashing	-
Ready for operation	red, continuous	-
Holiday mode, cooling-down phase	orange, flashing	-
Holiday mode	orange, continuous	-
Child lock, unlocking procedure	-	red, flashing
Child lock, unlocked	-	red, continuous
Pot filling, unlocking procedure	-	yellow, flashing
Pot filling	-	yellow, continuous
Defects	magenta, flashing/continuous	magenta, flashing/continuous

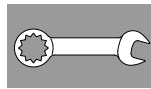

Installation and commissioning

Flush pipes thoroughly before and after installation (observe EN 806)!

Adjust bypass of filterhead according to local carbonate hardness and connect filter cartridge.

The carbonate hardness can be tested by using the enclosed test strip or the relevant water supplier can provide information on the carbonate hardness.

Note: The volume of water in the storage heater will expand as it is heated. The expansion water must drip out of the funnel of the safety assembly.

This is a necessary and completely normal process.

Check all connections for leakage.

Retighten screw connections as necessary.

Control:

The control is set for operation with the S-size filter cartridge (prod no.: 40 404 001) at the factory.

The control must be adjusted for operation with other filter cartridges, see page 9 - 10.



Operation, see page 11.

Unlock the child lock to draw off boiling water, see **A**.

The button combination for filling pots with boiling water, see **B**.

To get cold or hot water, see **C**.

Activating holiday mode, see **D**.

Note:

In order to prevent incorrect operation and for protection against injury, we recommend affixing the sticker provided.



Maintenance and cleaning

CAUTION!

■ Risk of damage!

Always disconnect from the voltage supply before carrying out maintenance work on the system. The plug-in connector can then be disconnected.

■ If work is performed on mains power supply or in case of any maintenance work, the GROHE Red boiling system must be bled as otherwise blasts of steam could form as a result.

- Draw off boiling water from the storage heater until just cold water flows.
- Close the service valve, switch off the storage heater and disconnect the mains plug.
- Open the lever on the fitting and as well as the rotary knob on the safety assembly to depressurise the storage heater.
- Drain the storage heater (not required each time maintenance is performed): Remove the cap or hose to the mixing valve and drain the storage heater using the connecting hose to the safety assembly.
- Inspect and clean all parts, replace as necessary and lubricate with special fitting grease.

Service

Fault ?	Cause !	Remedial action ✓
Boiling water does not flow, handle flashes magenta once	<ul style="list-style-type: none"> • Filter not installed correctly • Hoses kinked • Water supply interrupted 	<ul style="list-style-type: none"> - Insert filter straight (1½ - 2 turns) - Check hoses for kinks - Open shut-off valves fully
Boiling water does not flow, boiling water in use No display on the handle	<ul style="list-style-type: none"> • Software fault 	<ul style="list-style-type: none"> - Switch off the storage heater, briefly disconnect from the mains power supply and switch on again
Handle lights up magenta permanently	<ul style="list-style-type: none"> • System fault 	<ul style="list-style-type: none"> - Contact GROHE customer service

The GROHE boiling water storage heater may only be repaired by GROHE customer service.

Environment and recycling

For reasons of hygiene, it is not possible to recycle used filter cartridges. Used filter cartridges can be disposed of hazard-free as residual waste.

The boiling water storage heater is an electrical device, to which return and take-back obligations apply in many countries. GROHE participates in such take-back systems in all relevant countries.



Devices with this marking do **not** belong in domestic waste, but **must** be disposed of separately in accordance with the relevant national regulations.





A series of horizontal lines for writing, consisting of 24 lines in total, evenly spaced across the page.

Pure Freude
an Wasser

GROHE

D ☎ +49 571 39 89 333 service.de@grohe.com	F ☎ +33 1 49 97 29 00 sav-fr@grohe.com	NL ☎ +31(0) 88-0030700 https://www.grohe.nl/nl_nl/once-service/contact.html	TR AZ TM TJ ☎ +90 216 441 23 70 service.turkey@grohe.com
A ☎ +43 1 6 80 60 info-at@grohe.com	FIN ☎ +358 (09)42451390 grohe@grohe.fi	NZ ☎ +64 09 573 0490 sales@robertson.co.nz	UA ☎ +380 (44) 5375273 info-ua@grohe.com
AUS ☎ 1800 080 055 customer.care@reece.com.au	GB ☎ +44 208 283 2840 info-uk@grohe.com	P ☎ +351 234529620 comercial-pt@grohe.com	USA ☎ +1 800 4447643 Grohetechcare@lixil.com
B ☎ +32 (0)2 899 3077 https://www.grohe.be/nl_be/once-service/contact.html	GR ☎ +302102712908 service-gr@grohe.com	PL ☎ +48 (22) 5432640 biuro@grohe.com	VN ☎ (+84) 1800 6624 cskh@lixil.com
BG ☎ +359 2 971 99 59 info-bg@grohe.com	H ☎ +36 (06)1 238-8045 info-hu@grohe.com	RI ☎ 0800-1-047-643 customercare-indonesia@lixil.com	AL BiH HR KS ME MK SLO SRB ☎ +385 1 2911470 adria-hr@grohe.com
BR ☎ 0800 770 1222 falecom@lixilamericas.com	HK ☎ +852 2969 7067 info@grohe.hk	RO ☎ +40 021 212 50 50 info-ro@grohe.com	CY MT IL ☎ + 357 22465200 service.cyprus@grohe.com
CAU ☎ +99 412 497 09 74 info-az@grohe.com	I ☎ +39 2 959401 info-it@grohe.com	ROK ☎ +82 2 1588 5903 info-singapore@grohe.com	UAE KWT BHR OM PK ☎ +971 4 421 4556 service.UAE@grohe.com
CDN ☎ +1 888 6447643 info@grohe.ca	IND ☎ 18001024475 customercare.in@grohe.com	RP ☎ +63 2 89288000 service_center@wilcon.com.ph	KSA LBN JOR IRQ QAT ☎ +961 76868616 service.lebanon@grohe.com
CH ☎ +41 44 877 73 00 info@grohe.ch	IS ☎ +354 515 400 grohe@byko.is	RUS ☎ 8 800 200 00 49 service-ru@grohe.com	EGY SUD LBY ☎ + 202 26147988 service.egypt@grohe.com
CN ☎ +86 4008811698 info.cn@grohe.com	J ☎ +81-3-5775-7500 info_grohe@blisspajapan.jp	S ☎ +46 771 14 13 14 grohe@grohe.se	MA DZ TN NGR BJ GH CI SN ☎ + 202 26147988 service.morocco@grohe.com
CZ ☎ +420 277 004 193 info-cz@grohe.com	KZ ☎ +7 775 007 05 27 service-kz@grohe.com	SGP RC ☎ +65 6311 3611 grohe@connectcentre.sg	Far East Area Sales Office: ☎ +65 6311 3600 info@grohe.com.sg
DK ☎ +45 44 65 68 00 grohe@grohe.dk	MAL ☎ 1800 80 6570 customerservice.my@lixil.com	SK ☎ +421 948 119 343 info-sk@grohe.com	Latin America: ☎ +52 818 3050626 info@lixilamericas.com
E ☎ +34 93 / 3 36 88 50 grohe@grohe.es	MX ☎ 01 800 839 1200 info@lixilamericas.com	T ☎ +6629014455 grohe-thailand@lixil.com	
EST LT LV ☎ +372 661 6354 grohe@grohe.ee	N ☎ +47 22 07 20 70 grohe@grohe.no		