

*Pure Freude
an Wasser*

GROHE
WAVE

FIRST CLASS SEATS FOR EVERYONE

ENJOY THE SHOWER TOILET THAT CLEANS YOU WITH
PURE, WARM WATER. **GROHE SENSIA ARENA**



THE GROHE SENSIA ARENA. ALL THE FEATURES – **AT A GLANCE.**

CLEANER



Twin shower arms



Rear spray



Rear soft spray



Lady shower



Massage spray



Oscillating spray



Unlimited warm water supply



Odor absorption

MORE HYGIENIC



AquaCeramic



HyperClean



Triple Vortex



WRPDWLF7H01E0HDQLOJ1
of the spray arms



PlasmaCluster



3UHK1¹

MORE CONVENIENT



Dryer



Night light



Automated lid



Smartphone app



Remote control



Control panel on the seat



Descaling



WRPDWLF7K1¹



Rear spray



Massage spray



Odor absorption



Lady shower



Oscillating spray



Twin shower arms

¹Optional feature, in combination with product 46 944 001

A NEW DIMENSION OF HYGIENE: **PLASMACLUSTER.**

LET IONS CLEAN YOUR TOILET. Our PlasmaCluster¹ technology removes bacteria, even those hiding in the farthest corner of the bowl or the ceramic surface. It does this through releasing positive and negative ions, which make the bacteria harmless upon contact. Turn science into comfort with this natural technology and experience a cleaner and healthier toilet.

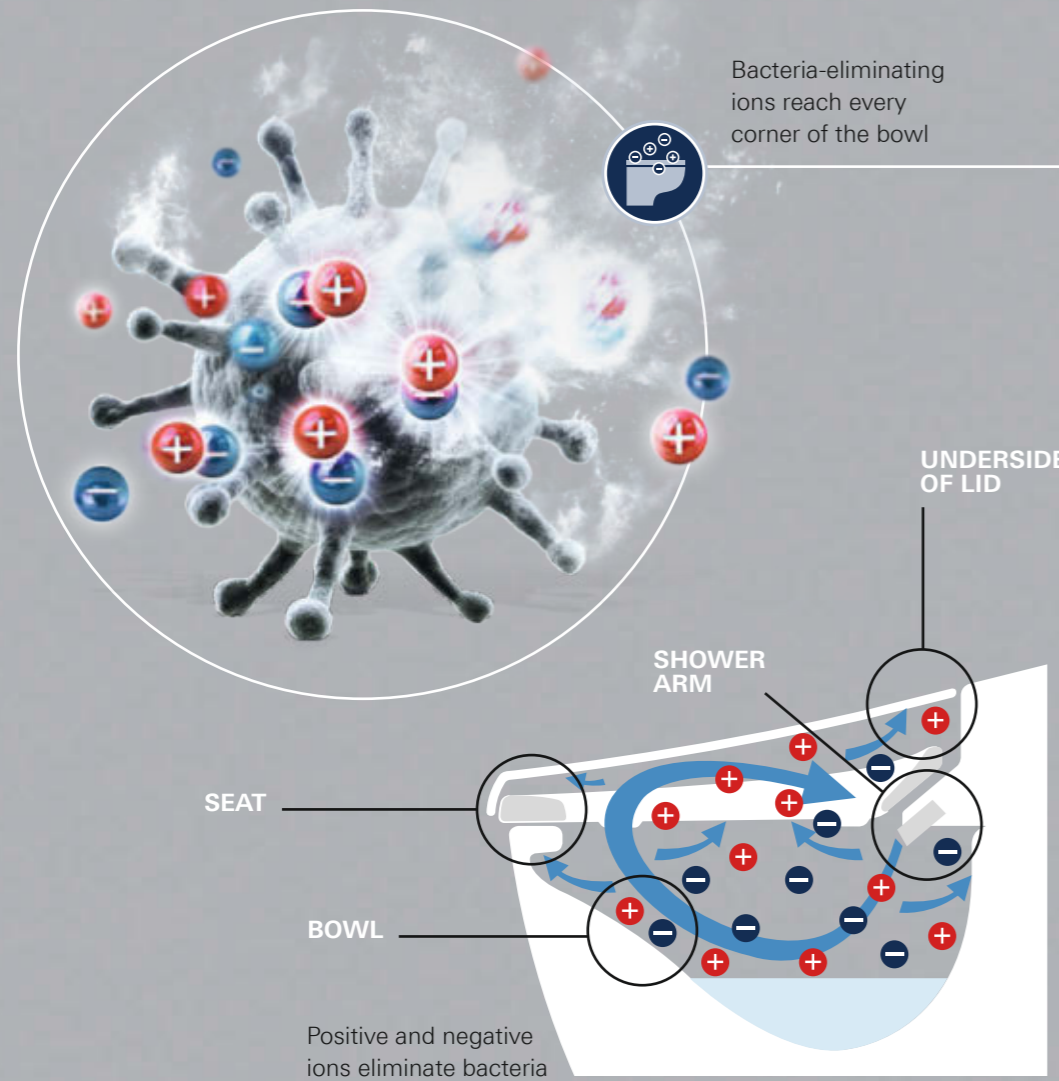

¹PlasmaCluster and the PlasmaCluster logos are registered trademarks of Sharp Corporation.

FROM WORLD-CLASS HOTELS TO YOUR BATHROOM.

Many of the best hotels around the world have already selected the GROHE Sensia Arena. Be inspired and bring some luxury into your bathroom too.



LA CHENEAUDIÈRE,
COLROY-LA-ROCHE,
FRANCE

PHOTOGRAPHY: Noshe



PHOTOGRAPHY: Noshe



PHOTOGRAPHY: Jonathan Savoie

This five-star spa hotel offers visitors a welcome break from their everyday lives and sports a design as naturally elegant as the mountain vistas surrounding it.



PHOTOGRAPHY: Noshe

WALDORF ASTORIA,
BERLIN,
GERMANY



Elegant and ageless, this branch of the classic New York chain is housed in a skyscraper overlooking the world-famous Berlin Zoo.



PHOTOGRAPHY: Maarten Willemstein



With an eclectic mix of vintage and contemporary design that suggests the home of a well-traveled friend, this hotel offers guests the perfect place to watch the sunset.



VESPER HOTEL,
NOORDWIJK,
NETHERLANDS



SIMPLE AND QUICK INSTALLATION.

FIT YOUR SHOWER TOILET TO A NEW BATHROOM OR WITHIN YOUR EXISTING SCHEME – IT'S ALL BEEN DESIGNED TO BE SO EASY. GROHE Rapid SL frame is designed for swift installation behind the wall, neatly concealing everything you need to run your shower toilet. It can be installed over existing tiles or for new schemes. With GROHE's glass module you can pick from a Velvet Black or MoonWhite safety glass module that conceals the water supply.



- [1] Connection box for water supply Sensia IGS and Sensia Arena
- [2] Water connection for Sensia IGS
- [3] Protection block for flush pipe and waste bend (as well as mounting pattern for tiler)
- [4] Integrated fixing point for electro cable Sensia Arena
- [5] Conduit pipe to guide the water connection hose

FOR MODERN CONCEALED INSTALLATIONS.

THE NEW GLASS COVER COMBINES NOBLE MATERIALS WITH HIGH FUNCTIONALITY. The cosmopolitan design creates a modern clean look in every bathroom with an ultra-slim design provided by an evenly built-in actuation. It is the ideal solution for when you want to upgrade your regular toilet to the Sensia Arena shower toilet, enabling an invisible connection without damaging the tiles.



39 374 KS0
Glass Cover
Skate Cosmopolitan
Velvet Black

39 374 LS0
Glass Cover
Skate Cosmopolitan
MoonWhite

DESIGN YOU CAN COUNT ON.

Facts and figures that guarantee a perfect match.



39 354 SH1
Sensia Arena shower toilet
wall-mounted

optional:
Automatic flushing upgrade kit 46 944 001



Remote Control
Control every function of the GROHE Sensia Arena with the intuitive remote control, which can be wall-mounted within arm's reach.

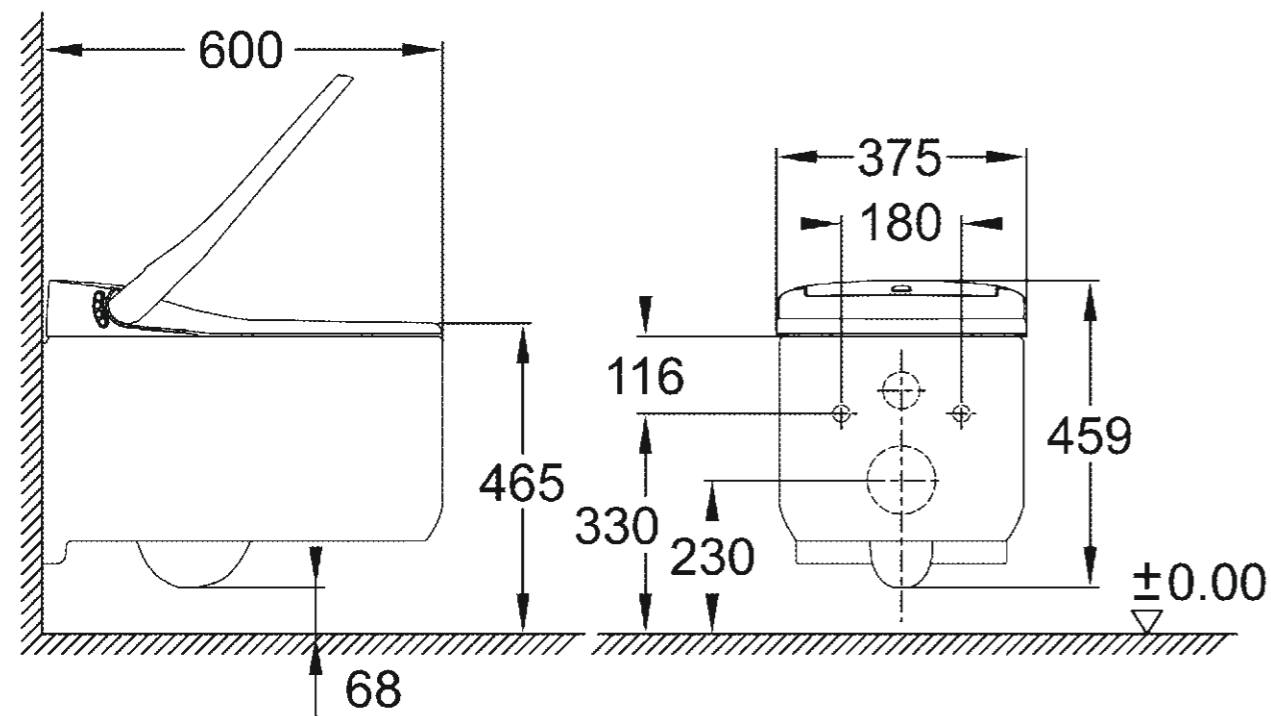

QUALITY DOWN TO THE LAST DETAIL.

CONSUMPTION

Flushing water volume Full/half flush (l)	5 l/3 l
Energy consumption (standby) (W)	< 0.5 W
Rated power consumption	850 W
Spray water flow rate (Rear spray/lady shower)	0.4 – 0.5 (l/min)

CONNECTIONS

Water pressure	0.5 – 10 bar
Water connection	3/8"
Outlet direction	P (horizontal)
Power supply	220 – 240 V AC
Frequency	50/60 Hz

COMFORT

Water temperature	32 – 40 °C
Dryer temperature	40 – 55 °C
Dryer air flow rate	23 m ³ /h
Odor absorption air flow rate	2.4 m ³ /h
Warm water supply	Unlimited
Weight (kg)	41.5 kg (product), 49.5 kg (total package)

CERTIFICATION

IP class	IPx4
	DVGW
	EN 1717
	CE
	Type of antibacterial agent used: inorganic anti-bacterial agent
SIAA (antibacteria)	Method of antibacterial treatment: firing
	Anti-bacterial treatment portion: water flowing surface
	Registration number: JP0122008A0038Z



5 GOOD REASONS TO UPGRADE YOUR BATHROOM.

1. FEEL PERFECTLY CLEAN.

Having pure, warm water cleaning you at the push of a button.

2. ULTIMATE HYGIENE.

The shower arms are rinsed with water before and after every usage.

3. COMFORT ZONE.

Integrated odor absorption eliminates bad smells.

4. TOUCH-FREE.

The lid opens automatically without having to touch it.

5. EASY TO CLEAN.

Thanks to a rim-free design, Triple Vortex flushing, an antibacterial coating, and the new PlasmaCluster.

DISCOVER THE WORLD OF GROHE

What you see here represents just a small selection of what the world of GROHE has to offer. Whether you are looking for ideas and inspiration or solutions for bath and kitchen, here's where you'll find it.

Just scan the QR codes to view the latest brochures as download or PDF on your tablet or smart phone. Or visit the world of GROHE at grohe.com



CERAMICS BROCHURE

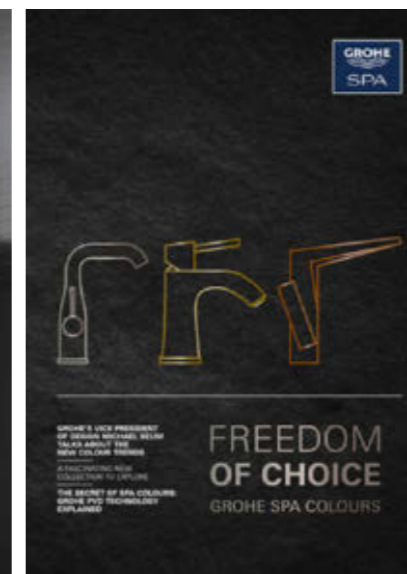

SPA COLOURS BROCHURE



BATH BROCHURE



Follow us



QUALITY

*"No.1 most trusted brand
in the sanitary industry" –
Wirtschaftswoche, 2017*



TECHNOLOGY

*"Top 50 companies
to change the world" –
Fortune Magazine, 2017*

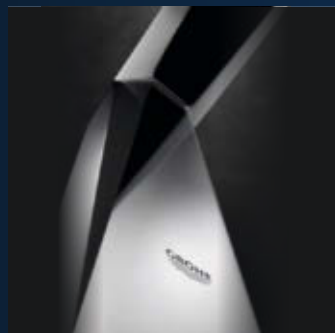

DESIGN

*Over 350 design awards
won since 2003*



SUSTAINABILITY

*CSR Award winner of the
German Government, 2017*

Grohe AG
Feldmühleplatz 15
D - 40545 Düsseldorf
Germany

© 11/2018 – Copyright by GROHE

PART OF LIXIL