

*Pure Freude  
an Wasser*

**GROHE**  
~~~~~

# GROHE CERAMICS

DESIGN & TECHNOLOGY, PERFECTLY MATCHED



**GROHE | MASTERS OF TECHNOLOGY**

**MICHAEL POTTHOFF**

Master of Technology, uses a 3-D measuring table to ensure that ceramic sanitaryware and faucets are perfectly compatible.

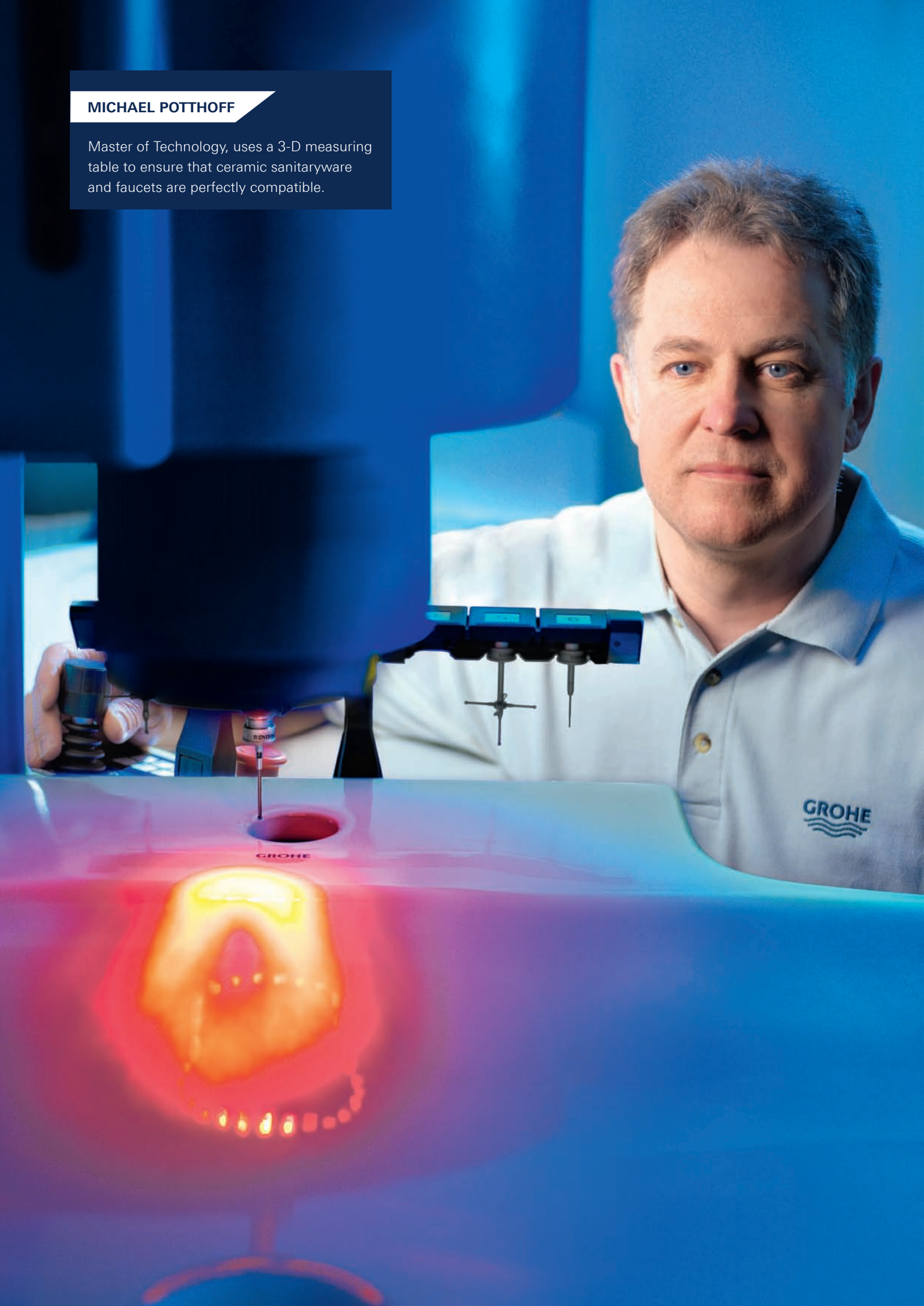

# MASTERS OF TECHNOLOGY

GROHE's people have been regarded by their peers in the industry as Masters of Technology, because of their innovations, outstanding design and award-winning fittings.

By a combination of their advanced craftsmanship and their cutting-edge approach to effective teamwork and processes, our Masters of Technology take the lead in developing, designing and manufacturing our outstanding product range, all the while testing and fine-tuning each piece to ensure continued customer satisfaction.

The result: Timeless design. And quality that lasts a life-time. Again and again GROHE products surprise users with unique features that provide 'Pure Freude an Wasser'. When you use a GROHE product you can feel the difference. Time after time.

For over a century GROHE's Masters of Technology have developed faucets, showers and accessories that use world-beating technology to deliver an exceptional bathing experience. Now, they are proud to draw on another wealth of expertise to bring you bathroom sanitaryware designed to create a harmonious, beautiful space just for you.

As part of the Lixil group, GROHE is able to build on more than 100 years of experience in sanitary ceramics to make the modern bathroom a cleaner, more inviting place. Now, working in tandem, these two strands of bathing excellence combine to create a range of sanitaryware, with GROHE's premium design and sophisticated ceramic technology.

The result is a collection of bathroom ceramics that are beautiful, sculptural and technologically sophisticated, working seamlessly with GROHE's faucets and fittings for a perfect marriage of form and function.





01  
SUPERIOR  
**TECHNOLOGY**

02  
PERFECT  
**MATCH**





# ENHANCE THE PURE **JOY OF WATER**

**Your bathroom should be a source of joy, a place of wellbeing and harmony.** Your own retreat away from the stresses of daily life where you can regain some balance, and where the fundamental element of life-giving water is delivered to you in ways that soothe, clean, invigorate and stimulate.

By combining highly innovative surface treatments with superior flushing expertise GROHE ceramics feature state-of-the-art technologies for the cleanest bathroom experience ever. Our experts can also help you to meet your design challenges: GROHE offers perfectly matching faucets and ceramics rated on four criteria - Design, Comfort, Water Delivery and Completeness – guaranteeing world-class coordinated design and technical compatibility. From sleek, striking design to unrivalled performance, GROHE ceramics leave nothing to chance.





# 01 DECADES OF EXPERTISE, **SUPERIOR TECHNOLOGY**

**Smooth, durable, hygienic and elegant** – GROHE ceramics combine decades of technological expertise with a refined design aesthetic you'll love.

With GROHE ceramics you'll have the reassurance that technologically you're fitting the best. GROHE has build on deeply on Japanese expertise in ceramics and hygiene technology, meaning your ceramics are easy to clean and easy to maintain for years to come. From details like GROHE's ProGuard anti scale and dirt finish and the HyperClean glaze that prevents bacteria from growing, to the super-powerful Triple and Double Vortex flush on our WCs, an array of technologies all work together to make GROHE ceramics the most hygienic, durable and beautiful on the market.



# TAKE CONFIDENCE FROM ULTIMATE HYGIENE



## GROHE PROGUARD – TOO SMOOTH FOR DIRT TO STICK

GROHE ProGuard creates a smooth surface that scale and dirt can't stick to, meaning dirt or residues cannot attach to the ceramic. This innovative surface treatment uses a layer that creates a floating 'lotus' effect to prevent limescale and residues sticking, staining and attracting further dirt and grime. Alongside GROHE's HyperClean finish it locks out dirt and bacteria for good, making cleaning effortless and maintaining the sparkling, fresh-from-the-box finish.







## GROHE HYPERCLEAN – NO CHANCE FOR GERMS TO GROW

Take confidence that your bathroom is hygienic and clean with GROHE HyperClean, which uses naturally anti-bacterial silver ions to inhibit germs and prevent stains and odour. During the glazing process this exceptionally smooth and hardwearing finish is added which prevents 99,9% of bacteria growth, meaning your ceramics stay sparklingly clean and germ-free with the minimum of effort. Take peace of mind from this Society of Industrial-Technology for Antimicrobial Articles-certified feature, making your bathroom a safer, cleaner and germ free place for you and your family.



Ceramic materials proudly feature the SIAA (Society of Industrial-technology for Antimicrobial Articles) brand mark based on ISO for KOHKIN – stringent criteria for the antibacterial effect and the safety of the agent.

## GROHE HYPERCLEAN PREVENTS BACTERIA GROWTH



without HYPERCLEAN



with HYPERCLEAN



# INNOVATION FOR THE **CLEANEST BATHROOM EVER**



## GROHE TRIPLE VORTEX® – THE POWER OF THREE

Unlike other toilets, GROHE's innovative triple vortex flush system creates a powerful vortex of water that swirls to cover and clean the whole of the bowl. Despite its power, this effective flush has low water consumption, with a dual flush option that uses just 5L of water and only 3L for a short flush. Instead of one or two water outlets, the Triple Vortex system flushes from three outlets creating an incredibly powerful flush that leaves nothing behind.



## GROHE DOUBLE VORTEX – DOUBLE STRENGTH CLEANING

A powerful flush that creates a whirlpool of water to clear and clean the whole of the bowl, every time. The Double Vortex is created with syphonic flushing technology and has two water outlets in the top of the bowl, for a completely clean bowl with very low water consumption – just 4.8L for a full flush and 3L for a short flush.



## GROHE RIMLESS – LEAVES BACTERIA NOWHERE TO HIDE

Corners and crevices are playgrounds for bacteria, especially under the rim of the toilet bowl. That's why we've created the 'rimless' bowl where every surface is easy to reach and effortless to keep clean, even in the parts you can't see. Its clever shape works together with the Triple Vortex flush so that the whole bowl is washed up to the very top of the bowl with every flush, but no splashes will escape. It all adds up to make GROHE toilets the easiest to clean option, leaving you plenty of time for more enjoyable things!

PERFECT MATCH

# 02 WORLD-CLASS DESIGN, **TAILORED TO YOU...**

If you choose GROHE ceramics you can be sure that you are creating a coherent, perfectly matched bathroom scheme style – faucets, shower, basin and toilet can all be chosen from the same range, with each designed to work together in a beautiful whole. We've even created a website and app to help you find the perfect faucet for you basin so everything runs smoothly.

Every individual, every home, every bathroom has its own distinct style. You may be a committed minimalist, in love with clean lines and sleek, simple shapes; perhaps you have a sensual side, attracted to tactile designs and graceful curves; or maybe your go-ahead, modern style reflects your busy life that values practical, pure, good-looking products. Whatever your lifestyle, whatever your taste, you'll find the perfect combinations of products for you within GROHE's four ceramics ranges. Each has its own distinctive qualities, just like you, and they make creating a visually unified bathroom that's personal to you simple and fun.







PERFECT MATCH

# ... AND TO YOUR GROHE FAUCET LINE

**Choice is great – but too many options can feel overwhelming.** When you're designing a new bathroom you want to be sure that your tap and basin fit perfectly together so that water doesn't splash and you have enough room for total comfort. To make sure that you select the right faucet for your preferred basin, first time, GROHE has developed the PerfectMatch website and app. Simply select the basin you want to install and you'll immediately find the taps that are right for it, tested by our experts for optimum performance and design harmony. No hassle, and no mistakes, it's the effortless way to find your bathroom's perfect match first time. You can browse through the matches suggested or narrow down the results using a number of helpful filters. It lets you find your perfect faucet and basin combination in three easy steps.

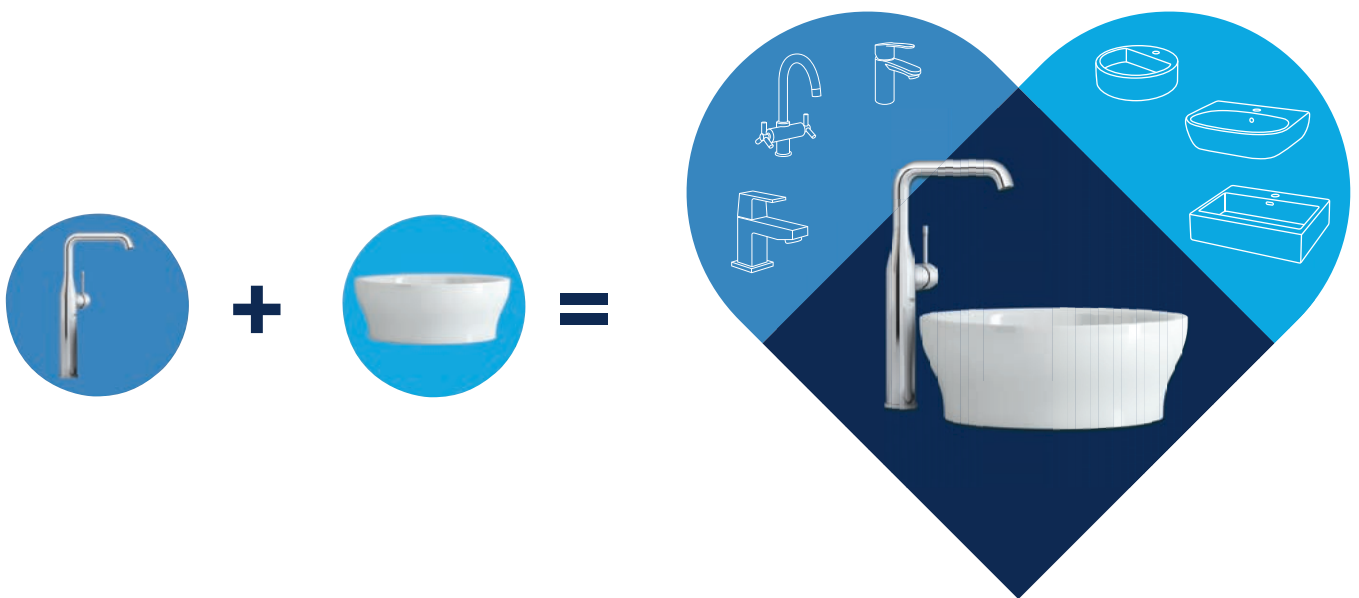

FIND YOUR PERFECT  
COMBINATION  
**WITH THE GROHE  
PERFECTMATCH APP**

DOWNLOAD FREE AT – [GROHE.COM/PERFECTMATCH](https://www.grohe.com/perfectmatch)



Apple, the Apple logo, iPad, and iPhone are trademarks of Apple Inc., registered in the U.S. and other countries. App Store is a service mark of Apple Inc. Google Play is a trademark of Google Inc.

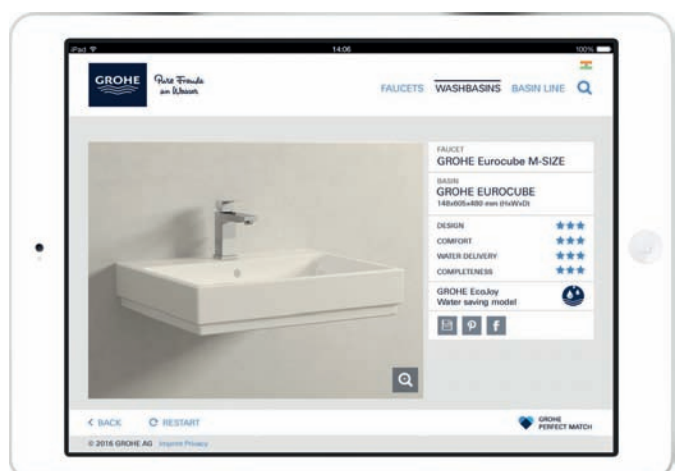



# A GROHE PERFECTMATCH = 100% TESTED COMBINATION

**No need to rely on trial and error when matching your basin and faucet** – our in-house experts have already tested every possible combination to find the perfect matches, making your life easier. Our dedicated design team looked at each individual product to determine which faucet and basin shapes look best together, guaranteeing you a seamless, complete design aesthetic. Then we physically tested our products against four criteria to make sure every suggested faucet and basin combination offers you a perfect match:

## FEASIBILITY TEST



Does the faucet fit neatly onto the basin and work to its technical capacity?

## SPLASH TEST



When the faucet is turned on, does the water flow splash over the basin?

## HAND WASH SPLASH TEST



When you wash your hands does it cause excessive splashing?

## COMFORT TEST



Is there enough space and height around the spout for easy, comfortable use?

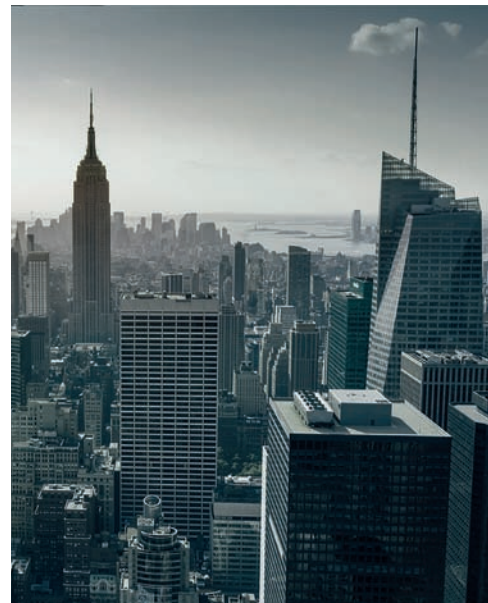



# GROHE EUROCUBE A CLEAR STYLE STATEMENT

**Step away from a busy, cosmopolitan life for a moment**

**and enjoy the essential.** With its strong, minimalist lines the stunning Eurocube collection sums up cool and contemporary bathroom luxury. Every product in the collection has a sophisticated rectilinear feel, modelled on the crisp, clean lines of the cube. The dynamic shapes and smooth surfaces are designed to be fuss-free, ideal for creating a modern bathroom scheme that brings a sense of calm clarity to your day.



# CUBIST CLEAN LINES **FORM A HARMONIOUS WHOLE**

Create a bathroom scheme that optimises effortless, urban chic with ceramics and brassware from the Eurocube range. Take inspiration from the shapes of the city and bring the dynamic lines of Eurocube's bath, basins and wall-hung WC together for a room that's a sleek, fuss-free oasis from the hectic world outside.





**Meet your own exacting standards with ceramics and faucets from the Eurocube collection.** With every detail based on the crisp shape of the cube, you can be certain of a distinctive precision to the finished look, with every line and edge in perfect harmony.





**Greet the day with clarity.** Rectilinear shapes and dazzling surfaces create a bathroom that delivers a sense of ordered calm and wellbeing, setting you up for the day ahead.





**Be inspired by the timeless quality of architectural design.** Eurocube's range of basin designs have been created to suit your own personal style and routine, but all are united by crisp profiles and clean corners for an effortlessly contemporary look.

Architectural rigour and dynamic design ideas define Eurocube, even down to the distinctive wall-hung WC.







**Everything in its place.** With Eurocube your love of precision can be carried through to your whole bathroom. Rectilinear shapes and great GROHE performance mean your ceramics will sit perfectly together down to the last detail.

# GROHE Eurocube

## Washbasin



**39 231 000**

Washbasin wall hung 60  
Alpine White

**39 234 000**

Counter basin 60  
Alpine White

**39 311 000**

Counter basin built-in 60  
Alpine White

## WC



**39 244 000**

WC - Wall hung  
Alpine White

## Bath



**39 159 000**

Bath tub - drop-in 180 x 80  
Alpine White



GROHE  
PowerFlush



GROHE  
Hygiene



Rimless  
WC Design



Triple  
Vortex



Pro  
Guard



Hyper  
Clean

For technical drawings please see page 56.

NEW





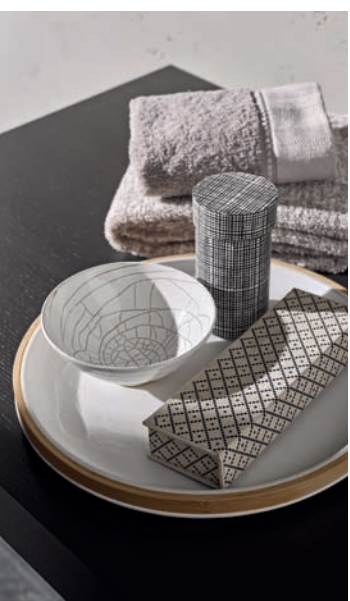

# GROHE EUROCOSMO CREATIVE INSPIRATION FOR DESIGN CONNOISSEURS

**Make your bathroom out of the ordinary, a space that doesn't just soothe but also stimulates.** A place of escape where creative details and a lightness of touch combine to form a space that will give you pleasure each time you use it. Let the Red Dot Design Award winning ceramics of the Eurocosmo collection express your own individuality in a space that gives you the freedom to drift away in thought...









# YOUR RETREAT FOR MIND AND BODY

Open up your bathroom to create a calming retreat that fosters thought, relaxation and wellbeing with the Eurocosmo range. All the items in the Eurocosmo collection are defined by their soft, sensual curves and rounded, embracing shape. Putting them together makes it simple to build an inspired bathroom scheme that's all about you.



**Tactile and organic shapes create a bathroom that's all about you.** The sparkling ceramics and slim, light design of the faucets work together perfectly, inviting you to reach out and touch.







**Freedom that's functional.** Designed to appeal to your intuitive, creative side, Eurocosmo sanitaryware and faucets compromise nothing on functionality, with a range of basin styles to fit your life and your space.





**Discreet style to inspire. Good design doesn't need to shout.** With Eurocosmo the flowing lines make creating a relaxing bathroom that exudes understated luxury a breeze. From the basin to the sleek WC everything fits together just so.

**No harsh edges.** Soothing design down to every detail, the smooth shapes of Eurocosmo continue right down to the WC.



# GROHE Eurocosmo

## Washbasin



**39 070 001**  
Counter basin w/o overflow 78  
Alpine White



**39 291 000**  
Counter basin 60  
Alpine White



**39 122 001**  
Vessel basin 60  
Alpine White

## WC



**39 296 000**  
WC - Wall hung  
Alpine White



**39 075 001**  
Floorstanding 1 PC toilet  
Alpine White



GROHE  
PowerFlush



GROHE  
Hygiene



Rimless  
WC Design



Triple  
Vortex



Double  
Vortex



Pro  
Guard



Hyper  
Clean



## Bath



---

**39 154 000**  
Bath tub - drop-in 180 x 90  
Alpine White



---

**39 322 000**  
Surround for 39 154 000  
Alpine White



# GROHE EUROSTYLE **THE ART OF INTUITION**

**Create a bathroom that engages your emotions, a place where organic, harmonious design promotes a deep sense of wellbeing.** Inspired by nature, the shapes of Eurostyle have a sensual softness that will speak to your instincts, making the restful, beautiful bathroom of your dreams a reality.





A modern bathroom with a bathtub, a shower, and a large window overlooking a green wall. The bathtub is white and set on a tiled platform. A small wooden table with a stool is next to it. A shower is visible on the right side of the image. A large window at the top shows a green wall outside. The text "A RELAXING SPACE THAT WELCOMES YOU" is overlaid on the image.

# A RELAXING SPACE THAT WELCOMES YOU

Bathrooms should be comfortable, with ceramics that appeal to your sensual side. Create a space in which to relax, unwind and sooth away the stresses of the day with Eurostyle's complete collection of sanitaryware and brassware, inspired by nature.



**Let nature guide you.** No harsh lines, no jarring edges  
– Eurostyle takes its cue from the softness of the natural world to create a scheme that soothes.





**Subtle shapes, perfectly matched.** The organic shapes of Eurostyle make creating a bathroom where harmony reigns simple, with every item working seamlessly together.



**Trust your instincts.** Designed to fit together seamlessly, creating a harmonious bathroom scheme with Eurostyle's complementary range of basins, faucets and WC is effortless and instinctive.







**Organic style, inspired performance.** Eurostyle's soft lines hide sophisticated GROHE ceramics technology for a super durable, easy-clean ceramic that will last and last.

# GROHE Eurostyle

## Washbasin



**39 276 000**  
Counter basin built-in 60  
Alpine White



**39 216 000**  
Vessel basin 50  
Alpine White



**39 125 001**  
Washbasin under-counter 60  
Alpine White

## WC



**39 310 000**  
Floorstanding 1 PC toilet  
Alpine White



GROHE  
PowerFlush



GROHE  
Hygiene



Rimless  
WC Design



Double  
Vortex



Pro  
Guard



Hyper  
Clean

For technical drawings please see page 60.

NEW







# GROHE EUROSMART IN TUNE WITH YOUR LIFE

**Imagine a great looking bathroom that adapts effortlessly to your real life.** Where busy days start and end in a space that is both hugely practical but also fun and visually distinctive. The Eurosmart range of ceramics has been specially designed to match excellent performance with an attractive price, making a flexible, stylish bathroom that you'll enjoy day in, day out for years to come.





# DESIGNED FOR MODERN LIFE

Practical design that works with your busy life meets a distinctive shape that you'll love in the Eurosmart range of ceramics and brassware. Bring some colour to your busy life with a bathroom that looks great and fits your family like a glove.







**No need to compromise.** Eurosmart offers smooth lines that are lovely to touch while offering practical durability thanks to GROHE's easy-clean finishes. From bath to basin to WC, this range is designed to be enjoyed everyday, by everyone.





**Smart function meets style.** With Eurosmart's range of basin shapes it's easy to find the perfect match between faucet and ceramic – no splashes, no hassle, just a coherent design scheme you'll love for years to come.





**Integrated into your life.** Create a sleek look with an undermounted basin and matching tap – Eurosmart is flexible enough to offer a design solution that fits, whatever your style.



**A complete collection.** The attractive, rounded shapes of Eurosmart are continued into the three WC types, two wall-hung designs and a one-piece toilet, meaning whatever your bathroom design you'll find a solution that suits.





# GROHE Eurosmart

## Washbasin



**39 198 000**  
Counter basin 60  
Alpine White



**39 124 001**  
Vessel basin 60  
Alpine White



**39 125 001**  
Washbasin under-counter 60  
Alpine White

## WC



**39 126 001**  
WC - Wall hung  
Alpine White



**39 205 000**  
WC - Wall hung  
Alpine White



**39 119 001**  
Floorstanding 1 PC toilet  
Alpine White



GROHE  
Hygiene



ProGuard



Hyper  
Clean

## Bath



---

**39 150 000**  
Bath tub - drop-in 170 x 70  
Alpine White



---

**39 151 000**  
Bath tub - drop-in 180 x 80  
Alpine White



# GROHE Eurocube – technical drawings

## Washbasin

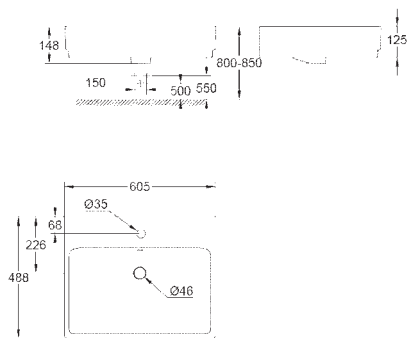

**39 231 000**  
Washbasin wall hung 60  
Alpine White

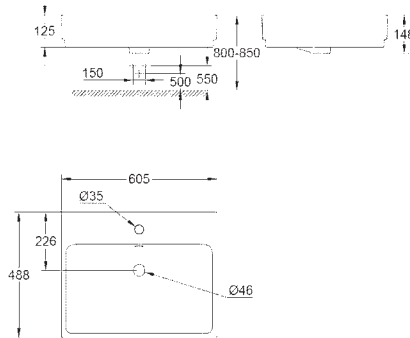

**39 234 000**  
Counter basin 60  
Alpine White

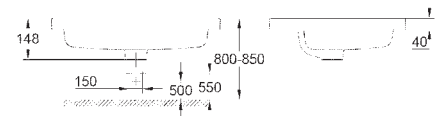

**39 311 000**  
Counter basin built-in 60  
Alpine White

## WC

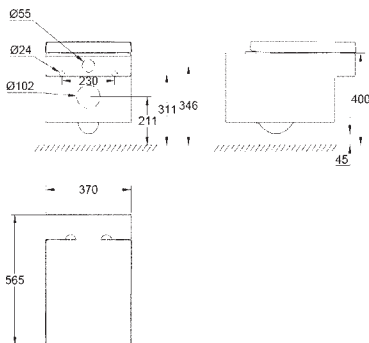

**39 244 000**  
WC - Wall hung  
Alpine White

## Bath

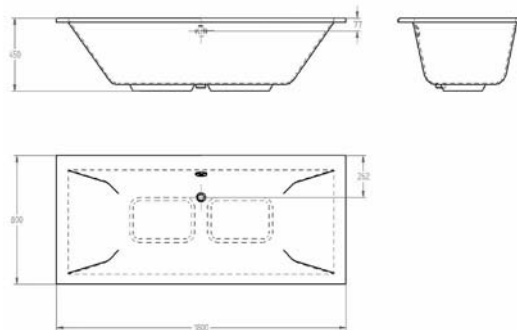

**39 159 000**  
Bath tub - drop-in 180 x 80  
Alpine White





# GROHE Eurocosmo – technical drawings

## Washbasin

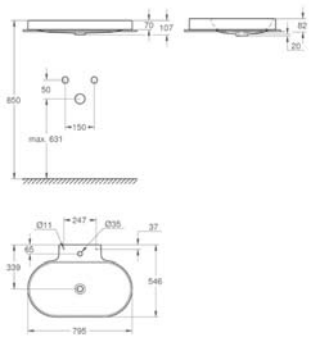

**39 070 001**  
Counter basin w/o overflow 78  
Alpine White

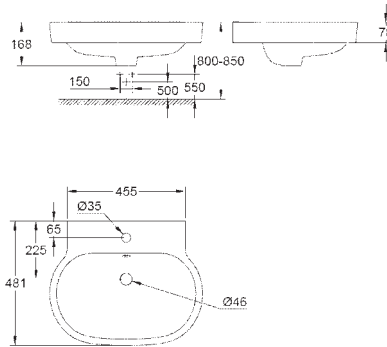

**39 291 000**  
Counter basin 60  
Alpine White

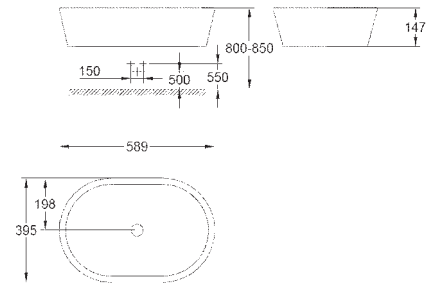

**39 122 001**  
Vessel basin 60  
Alpine White

## WC

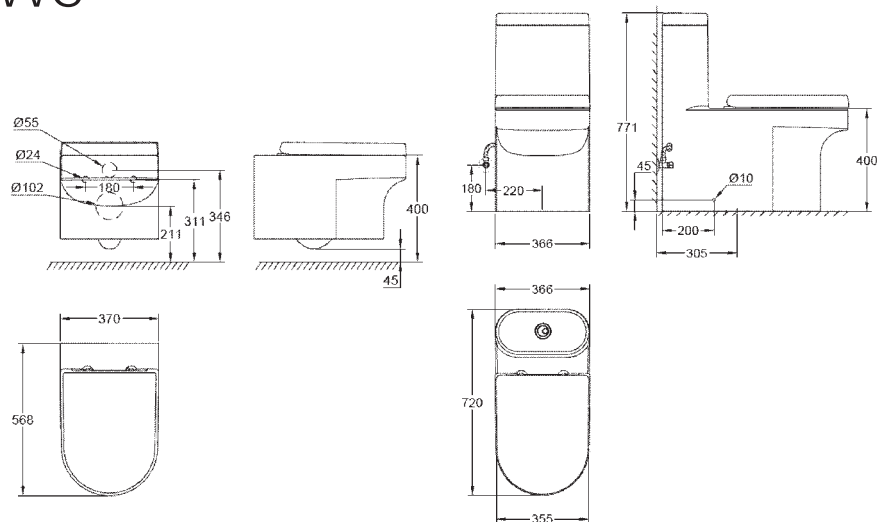

**39 296 000**  
WC - Wall hung  
Alpine White

**39 075 001**  
Floorstanding 1 PC toilet  
Alpine White

# Bath

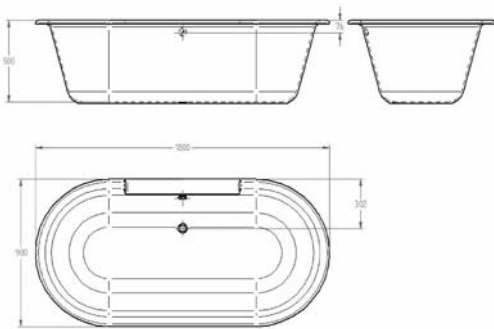

**39 154 000**  
Bath tub - drop-in 180 x 90  
Alpine White

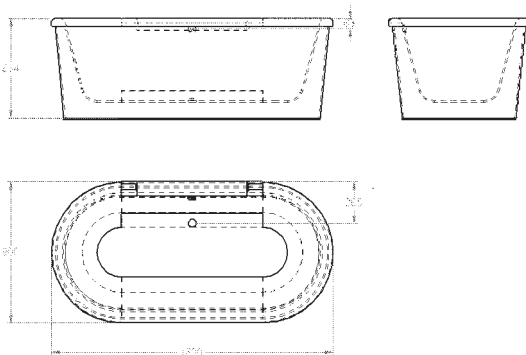

**39 322 000**  
Surround for 39154000  
Alpine White



# GROHE Eurostyle – technical drawings

## Washbasin

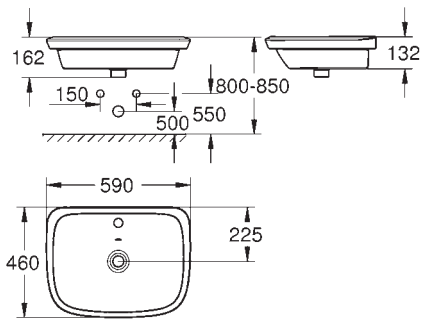

**39 276 000**  
Counter basin built-in 60  
Alpine White

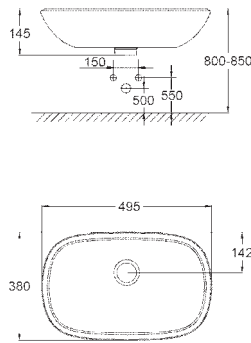

**39 216 000**  
Vessel basin 50  
Alpine White

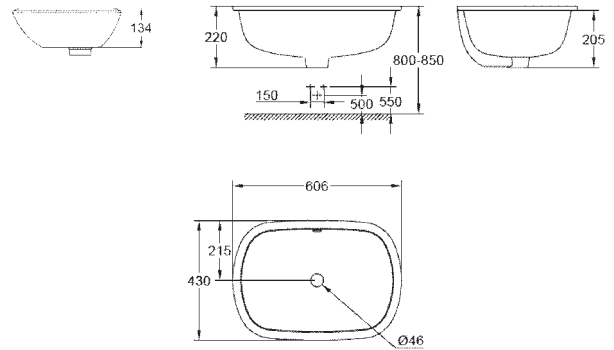

**39 125 001**  
Washbasin under-counter 60  
Alpine White

## WC

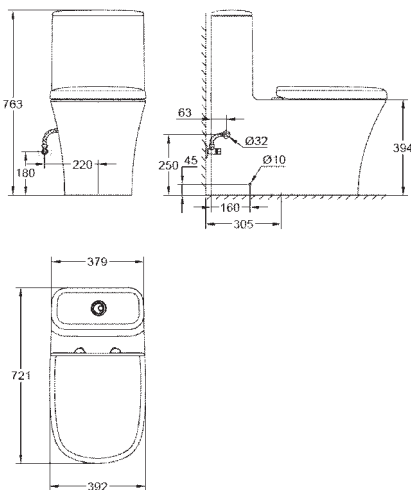

**39 310 000**  
Floorstanding 1 PC toilet  
Alpine White



# GROHE Eurosmart – technical drawings

## Washbasin

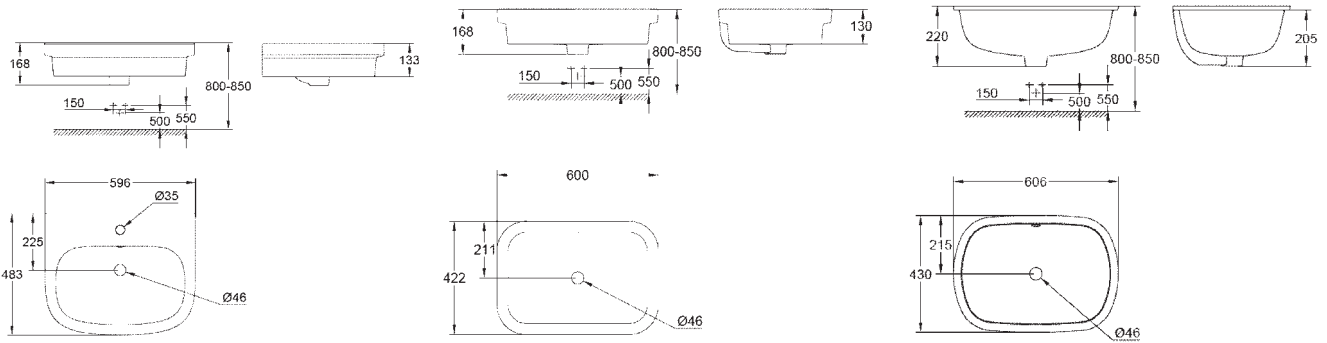

**39 198 000**  
Counter basin 60  
Alpine White

**39 124 001**  
Vessel basin 60  
Alpine White

**39 125 001**  
Washbasin under-counter 60  
Alpine White

## WC

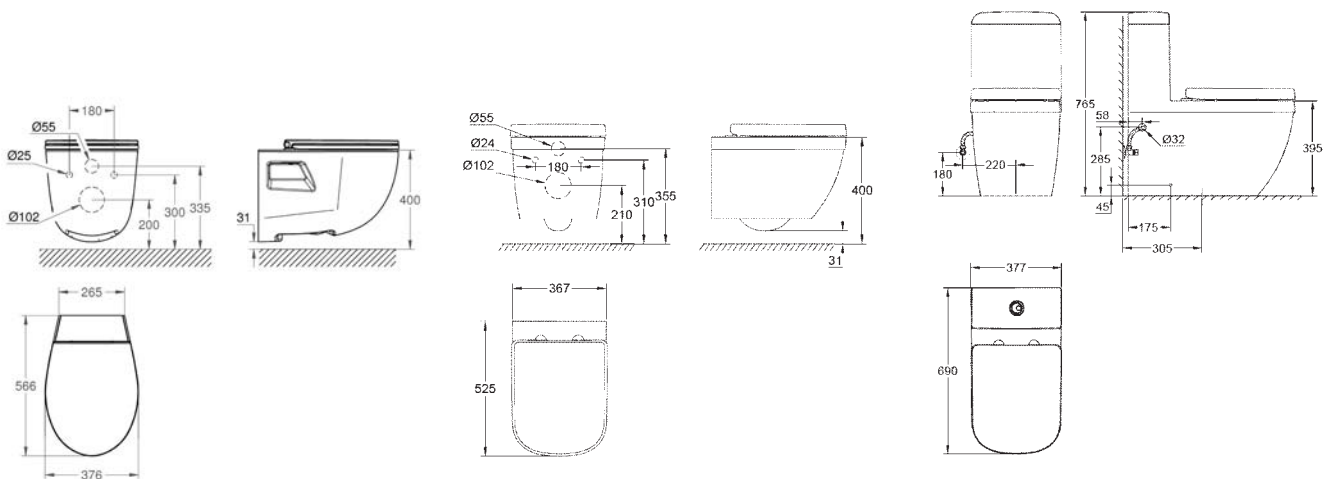

**39 126 001**  
WC - Wall hung  
Alpine White

**39 205 000**  
WC - Wall hung  
Alpine White

**39 119 001**  
Floorstanding 1 PC toilet  
Alpine White



# Bath

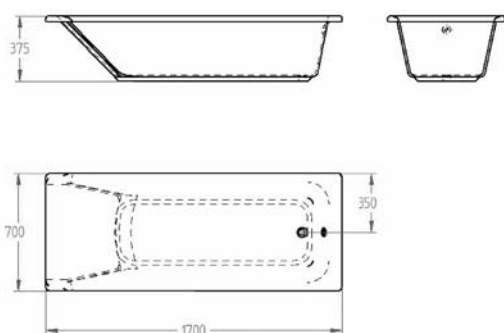

---

**39 150 000**  
Bath tub - drop-in 170 x 70  
Alpine White

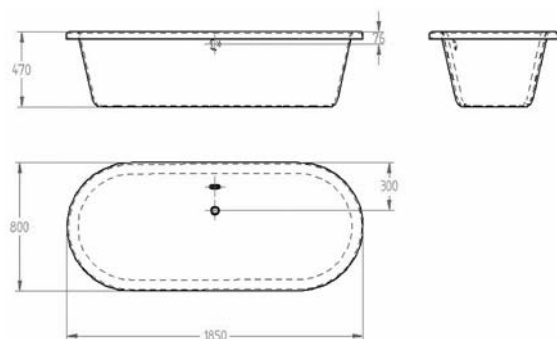

---

**39 151 000**  
Bath tub - drop-in 180 x 80  
Alpine White

GROHE.COM

Follow us



Grohe AG  
Feldmühleplatz 15  
D - 40545 Düsseldorf  
Germany

© 04/2016 – Copyright by GROHE

PART OF **LIXIL**